

# Data Communication Device L-02C

ISSUE DATE:

10.12

NAME:

PHONE NUMBER:

MAIL ADDRESS:

INSTRUCTION MANUAL

<sup>NTT</sup>  
docomo

Contents/Precautions

Before Using this Terminal

Setting Up

L-02C Connection Software

Mobile Broadband

Configuring Network Manually

Overseas Use

Appendix/Troubleshooting

# DOCOMO LTE • W-CDMA • GPRS System

## Thank You for Purchasing the "Data Communication Device L-02C"

Before or while using the L-02C, be sure to thoroughly read this manual and the individual manual for other operation devices to ensure its correct use. For further information, contact the "docomo Information Center" on the back of this manual. The L-02C is designed to be your close partner. Treat it carefully at all times to ensure long-term performance.

### Before Using this Terminal

- Because this terminal uses radio waves, it may not function in locations where it is difficult for radio waves to penetrate, such as tunnels, underground passages, Xi service area and some buildings in areas where radio wave signals are weak or out of the service area. Even when you are on a higher floor of a tall building or condominium and nothing blocks your view outside, this terminal may not be able to receive or transmit signals. Also communication may be interrupted even when the Antenna Indication Lamp on this terminal lights indicating a strong signal reception with 3 antenna indication bar.
- Use this terminal in ways that do not disturb others in public places, crowded locations, or quiet locations.
- This terminal communicates via radio waves by converting voices into digital signals. If you move into an area where signal reception is poor, the digital signals may not be accurately decoded and what you hear may differ slightly from what was actually said.

- DOCOMO is not responsible for any economic losses incurred through lost communication opportunities caused by external factors such as malfunction or electrical outage.
- This terminal can be operated in Xi area, FOMA Plus-Areas and FOMA HIGH-SPEED Areas.
- This terminal can be used only via Xi network, FOMA network provided by DOCOMO and DOCOMO's roaming area.
- This terminal does not support i-mode functions (i-mode mail, connection to i-mode sites (program) or i- $\alpha$ pli, etc.)

### For First-Time Users of this Terminal

If this is your first time to use this terminal, read the manual in the following order to learn basic operations.

1. Learning the precautions. . . . . P7
2. Learning the names of parts and functions of this terminal. . . . . P18
3. Inserting this terminal into a PC . . . . . P24
4. Having this terminal recognized by your PC. . . . . P30
5. Setting this terminal before communication . . . . . P56

The latest information of this manual can be downloaded from the DOCOMO website.

■ The URL of PDF for INSTRUCTION MANUAL  
<http://www.nttdocomo.co.jp/english/support/trouble/manual/download/index.html>

※ The URL and the information contained in the manual are subject to change without prior notice.

# How to Read/Refer to this Manual

## Contents

---

L-02C Manual is composed of "L-02C INSTRUCTION MANUAL~Connection Guide~" and "L-02C INSTRUCTION MANUAL (recorded in CD-ROM)" (this manual).

### ■ "L-02C INSTRUCTION MANUAL~Connection Guide~"

The following contents such as connection to computer, troubleshooting, specifications of L-02C are described.

- Contents/Precautions
- Before Using this Terminal
- Setting Up
- Appendix/Troubleshooting

### ■ "L-02C INSTRUCTION MANUAL (recorded CD-ROM)" (this manual)

Besides the above contents described in "L-02C INSTRUCTION MANUAL~Connection Guide~", the contents of configuring communication through special application are also written.

This manual is supplied with PDF. To view this manual, Adobe Reader (Version 6.0 or later is recommended) is necessary.

- L-02C Connection Software
- Mobile Broadband
- Configuring Network Manually
- Overseas Use

# How to Refer to this Manual

---

Use the following methods to search functions and services.

## From Index

→ **P124**

Search functions or services by function name or service name.

## From Tabs on Front Cover

→ **Front cover**

Search functions or services from index tabs printed on front cover.

## From Contents

→ **P5**

Search from the categorized contents.

## From Main Features

→ **P6**

Search the main features from here.



**See next page for detailed descriptions**

- Please understand that in "L-02C Manual", "this terminal" refers to "L-02C".
- Note that in "L-02C INSTRUCTION MANUAL", "PC" refers to both "Windows PC" and "Mac".
- Operation procedures and images may differ depending on environment.
- Reprinting all or parts of this manual is prohibited.
- Information contained in this manual is subject to change without prior notice.

Describes how to search in this manual through an example of installing L-02C connection software on Macintosh (including a driver).

## From the Index

### ► P124

Search a function or a service name as the example.

<b>I</b>	
Install	
Communication configuration file (Driver only)	34 38
Flash Player on Macintosh	48
Flash Player on Windows	37
L 02C Connection Software on Macintosh (including a driver)	43
L 02C Connection Software on Windows (including a driver)	33
<b>L</b>	
LTE	53
L 02C Connection Software	
Configuring Network	92
Confirming after Installation	39 46
Confirming the packet communication volume	56

P43  
This page describes installation of L-02C connection software on Macintosh (including a driver)"

To next page

## From Tabs on the Front Cover

### ► Front cover

Search a function in the order of "Front cover" → "Chapter title page" → "Target page" as the example.

Contents/Precautions	
Before Using this Terminal	
Setting Up	
L-02C Connection Software	
Mobile Broadband	
Configuring Network Manually	

<b>Setting Up</b>	
Setting Up .....	30
Windows Version .....	33
Macintosh Version .....	43

A section title.

Useful  
Information or  
instructions  
relating to  
operations.

### Macintosh Version

Installation of L-02C connection software is only required to install when connect this terminal to your PC for the first time  
※ The following images are the examples of Mac OS X 10.6  
Images may differ for Mac OS X 10.5

**Note**

- When installing, insert this terminal into USB port after OS is activated
- Do not insert the CD-ROM into CD drive when install at on via this terminal starts
- Do not remove this terminal while installing
- End all the applications before installing. Also end programs on Macintosh including virus check software
- When installing, make sure to install from the account with PC supervisor privileges

### Preparation before Using L-02C

#### Setting via this Terminal

- 1 Turn on the PC and activate OS
- 2 Connect this terminal with the PC  
CD-ROM icon is displayed on the desktop
- 3 Double click the CD-ROM icon
- 4 Double click "L-02C 接続ソフトウェアインストーラー.pkg (L-02C connection software installer.pkg)\*"



Setting Up 43

Explains  
operation  
procedures.

Key screens for  
operation  
procedures. Refer  
to screens on your  
PC. Numbers,  
settings or  
characters entered  
are for reference  
only.

Index:  
Searching a  
chapter is available.

※ : The above page is an example.

※ : Screen images and illustrations contained in this manual are for reference only. They may differ from the real product.

# Contents

How to Read/Refer to this Manual .....	1
Contents .....	5
Features of the L-02C .....	6
Safety Precautions (ALWAYS FOLLOW THESE PRECAUTIONS) .....	7
Handling and Care .....	13
Basic Package .....	16

<b>Before Using this Terminal</b> <b>17</b>	Names of Parts and Functions Using UIM Available Communications Connecting this Terminal to a PC
<b>Setting Up</b> <b>29</b>	Setting Up Windows Version Macintosh Version
<b>L-02C Connection Software</b> <b>51</b>	L-02C Connection Software Using Packet Communication Environment Configuration Checking The Newest Version of Software
<b>Mobile Broadband</b> <b>63</b>	Mobile Broadband Connecting through Mobile Broadband Disconnecting Mobile Broadband Changing APN Settings Setting UIM

## **Configuring Network Manually** **69**

Windows Version

## **Overseas Use** **89**

International Roaming Service (WORLD WING)  
Services Available Overseas  
Before Using Overseas  
Setting the Searching Method for Available Networks  
Configuring Network

## **Appendix/Troubleshooting** **95**

AT Commands  
AT Command List  
Troubleshooting  
Error Messages  
Warranty and After-Sales Service  
Updating Software  
Main Specifications  
Export Administration Regulations  
Intellectual Property Rights  
Index

## Features of the L-02C

"Xi" is a service of DOCOMO supported by LTE (Long Term Evolution) which is the international communication standard. FOMA (Freedom Of Mobile multimedia Access) is the name of a service provided by DOCOMO based on the W-CDMA system, which is certified as one of the global standards of 3rd generation mobile communication systems (IMT-2000).

### ■ Supported Xi data communication

This is a super high speed data communication of up to 37.5Mbps for receiving data and up to 12.5Mbps for sending data (Part of the indoor facilities within Xi area can reach the speed of up to 75Mbps for receiving data and up to 25Mbps for sending data). You can enjoy the broadband with the speed as fast as optical LAN and the quick access within short time.

- The maximum communication speed is calculated based on theoretical standard, not the real speed. It is provided by Best effort system. The real communication speed changes according to the communication environment and network condition.
- The FOMA area which is out of Xi area is also available.
- Refer to DOCOMO website for detailed areas support Xi.

### ■ Correspondence with the FOMA HIGH-SPEED Area

You can enjoy high speed communication (Best effort system) at a maximum of 7.2Mbps for receiving and 5.7Mbps for sending.

- Communication speed is theoretical values when sending and receiving data which does not show the actual ones. The actual communication speed depends on communication environment and network congestion.
- For details of areas supporting a maximum of 5.7Mbps for sending, view DOCOMO website.
- Sending and receiving data may become 384kbps even in the FOMA HIGH-SPEED area.
- Sending and receiving data become 384kbps in FOMA area out of FOMA HIGH-SPEED area.

### ■ International Roaming Service



Data communications from a PC are available through using 3G network or GPRS network in foreign countries. ▶P90

- ※ "WORLD WING" is usually applied along with the contract of this terminal. Please contact a docomo shop or a docomo Information Center to confirm the details.







## Safety Precautions (ALWAYS FOLLOW THESE PRECAUTIONS)

- Before using this terminal, read these "Safety Precautions" carefully so that you can use it properly. After reading the safety precautions, keep this manual in a safe place for later reference.
- These precautions are intended to protect you and others around you. Read and follow them carefully to avoid injury, damage to the product or damage to property.
- The signs below indicate the levels of danger or damage that may occur if the particular precautions are not observed .

 <b>DANGER</b>	This sign indicates that incorrect handling has a high possibility of causing death or serious injury.
 <b>WARNING</b>	This sign indicates that incorrect handling poses a risk of causing death or serious injury.
 <b>CAUTION</b>	This sign indicates that incorrect handling poses a risk of causing slight injury or damage to the product or property.

- The following symbols indicate special warnings regarding product usage.

 Don't	Denotes things not to do (prohibition).
 Not disassembly	Denotes not to disassemble.
 Not liquids	Denotes not to use where it could get wet.

 Do	Denotes mandatory instructions (matters that must be complied with).
--	--

- "Safety Precautions" are explained in the following 4 sections.

General Precautions for this Terminal and UIM .....	8
Precautions for this Terminal .....	9
Precautions for the UIM .....	11
Notes on Using near Electronic Medical Equipment .....	11

## General Precautions for this Terminal and UIM

### DANGER



Don't

Do not use or leave this terminal and UIM in places with a high temperature such as in cars under the blazing sun.

Fire, burns, or injury may result.



Don't

Do not put this terminal or UIM in heating appliances such as microwaves or high pressure containers.

Fire, burns, injury, or electric shock may result.



Not disassembly

Do not disassemble or remodel this terminal and its accessories.

Fire, burns, injury, or electric shock may result.



Not liquids

Do not get this terminal and its accessories wet with water, drinking water, pet urine, etc.

Fire, burns, injury, or electric shock may result.



### WARNING



Don't

Do not subject this terminal and its accessories to severe shocks, or throw them.

Fire, burns, injury, or electric shock may result.



Don't

Keep conductive foreign objects (metal, pencil lead, etc.) away from the USB connector. Do not insert such objects inside this terminal.

Fire, burns, injury, or electric shock may result.



Don't

Do not cover or wrap this terminal or its accessories with bedding, etc. while using.

Fire or burns may result.



Do

Make sure to turn off the computer which is connected with this terminal before you go near a flammable gas such as gasoline fumes.

Catching fire may result.



## CAUTION



Don't

Do not place this terminal or UIM on unstable locations such as wobbly tables or slanted locations.

This terminal or UIM may fall, resulting in injury.

---



Don't

Do not store this terminal or UIM in humid or dusty places, or in hot areas.

Fire, burns, or electric shock may result.

---



Do

If children use this terminal or UIM, a guardian should explain the precautions and correct operations. The guardian should also make sure that the instructions are followed during use.

Injury may result.

---



Do

Keep out of reach of babies and infants. Accidental swallowing or injury may result.

---

## Precautions for this Terminal



## WARNING



Don't

Do not get liquids such as water or foreign objects such as metal pieces or flammable materials into the UIM slot of this terminal.

Fire, burns, injury, or electric shock may result.

---



Do

Turn off this terminal in places where use is prohibited such as airplanes or hospitals.

Electronic devices or electronic medical devices may be adversely affected. Follow the instructions when using inside medical facilities.

---



Do

If you wear any implanted electronic medical devices, contact the manufacturer or dealer of the electronic medical device to ask about the effect from radio waves.

Electronic medical devices may be adversely affected.

---



Do

Remove this terminal from USB port in places near high-precision electronic devices or devices using weak electronic signals.

Electronic devices may be adversely affected by reasons such as malfunction.

※ Electronic devices that may be affected  
Hearing aids, implanted cardiac pacemakers, implanted defibrillators, other medical electronic devices, fire alarms, automatic doors and other automatically controlled devices.

If you are using an implanted cardiac pace maker, implanted defibrillator or any other electronic medical device, consult the manufacturer or retailer of the device for advice regarding possible effects from radio waves.

---



## CAUTION



Don't

**Do not use the broken terminal.**

Fire, burns, injury, or electric shock may result.

---



Do

**If you use this terminal in a car, contact the car manufacturer or dealer to ask about the effect from radio waves.**

Depending on the type of a car, in-car electronic devices could be adversely affected. In this case, stop using this terminal immediately.

---



Do

**Itching, rash or eczema may be caused depending on your physical conditions or predisposition.**

If an abnormality occurs, stop using this terminal immediately, and then seek medical attention.

For the material of each part →P12  
"Material List"

---



Do

**Be careful not to get your finger caught in the parts when you close or open this terminal.**

Injury or other accidents may result.

---

## Precautions for the UIM



### CAUTION



Do

Be careful not to touch the edge of UIM when removing it. Injury may result.

## Notes on Using near Electronic Medical Equipment

- The description below meets "Guideline on the Use of Radio-communication Equipment such as Cellular Telephones - Safeguards for Electronic Medical Equipment" by the Electromagnetic Compatibility Conference.



## WARNING



Do

Be sure to adhere to the following regulations inside medical facilities.

- Keep this terminal out of operating rooms, intensive care units (ICUs) or coronary care units (CCUs).
- Turn off the PC in hospital wards.
- Turn off the PC in hospital lobbies and corridors if electrical medical devices could be nearby.
- If the medical facility has specific zones where use or possession of mobile terminals is prohibited, follow those regulations.



Do

Turn off the PC in crowded trains or other public places where implanted cardiac pacemaker or defibrillator wearers could be nearby.

Operation of an implanted cardiac pacemaker or implanted defibrillator may be adversely affected by radio waves.



Do

If you use an implanted cardiac pacemaker or implanted defibrillator, use the mobile terminal 22cm or more away from the implanted cardiac pacemaker or implanted defibrillator.

Operation of an implanted cardiac pacemaker or implanted defibrillator may be adversely affected by radio waves.



Do

Patients using electronic medical equipment other than implanted cardiac pacemakers or implanted defibrillators (using outside medical facilities for treatment at home, etc.) should check the influence of radio waves upon the equipment by consulting the manufacturer.

Operations of electronic medical equipment may be adversely affected by radio waves.

## Material List

Part	Material/Surface treatment
Exterior case (Front part)	PC LUPLOY SC1004A (KPA1)/SF CLEAR (Aphotic 100%)
Exterior case (Back part: side, back)	PC LUPLOY SC1004A (KPA1)/SF CLEAR (Aphotic 100%)
Back Cover	PC LUPLOY SC1004A (KPA1)/SF CLEAR (Aphotic 100%)
Front Cover	PC LUPLOY SC1004A (EM59P)/SSCP 160 NCB (Euphotic 8 : Aphotic 2)
Exterior case (Back part: Surface)	PC LUPLOY SC1004A (EM59P)/SSCP 160 NCB (Euphotic 8 : Aphotic 2)
Stopper	URETHANE
PWR Lamp	ILD-7550/Diffusion PC (Milky)
Communication Status Lamp	ILD-7550/Diffusion PC (Milky)
USB connector bracket	LG Chemistry, SC2302 (KA02), PC+GF30%/SF CLEAR (Aphotic 100%)

## Handling and Care

### General Usage Guidelines

#### ■ Keep this terminal away from water.

This terminal and UIM are not waterproof. Do not use the terminal in places with high humidity such as a bath or where rain may get it wet. If you carry the card close to your body, moisture from sweat may corrode the internal parts causing a malfunction. Note that malfunctions deemed to be caused by water are not covered by the warranty, and may be impossible to repair. Since these malfunctions are not under warranty, even when repair is possible, it will be done at the user's expense.

#### ■ Clean this terminal with a dry, soft cloth (Lens cleaning cloth).

If this terminal is wiped with alcohol, paint thinner, benzine or detergent, the printing may disappear or color may fade.

#### ■ Keep the connector contacts clean with a dry cotton swab.

Clean the connector contacts with a dry cotton swab to prevent contacts from getting dirty which can result in intermittent connections. Be careful when cleaning the connector contacts.

#### ■ Do not place the equipment near air conditioner outlets.

Condensation may form due to rapid changes in temperature, and this may corrode internal parts and cause malfunction.

#### ■ Do not place this terminal where excessive force will be applied to it.

If this terminal is inserted to a full bag, or placed in a pocket and sat on, its internal PCBs may be damaged or malfunction. Such damage is not covered by warranty.

#### ■ Read the individual manual attached to this terminal.

### This Terminal

#### ■ Avoid using in extremely high or low temperatures.

This terminal should be used within a temperature range from 5 °C to 35 °C and a humidity range from 45 % to 85 %.

#### ■ This terminal may adversely affect fixed phones, televisions or radios in use nearby. Use as far as possible from such appliances.

#### ■ Keep a separate record of any information stored on this terminal and store the copies in a safe location.

DOCOMO assumes no responsibility for the loss of any of your data.

#### ■ Do not drop this terminal or subject it to shocks. Damage or malfunction may result.

- Do not insert an USB connector to PC crookedly or do not pull it when it is inserted.  
Damage or malfunction may result.
- Remove this terminal from the PC when transporting.  
Malfunction or damage may result.
- It is normal for this terminal to become warm during use. You can continue to use it even when it is warm.
- Take care not to drop this terminal when removing this terminal from the carrying case (Sample).
- When it is not in use, keep this terminal in its carrying case (Sample) to keep the connector contacts clean.  
Dirty contacts may result in intermittent connections.
- When putting this terminal in carrying case (Sample), keep it away from wet or high temperature place. Pay attention not to put excessive force on this terminal.  
Transformation and tarnish may result.

## UIM

- Do not put excessive force on the UIM when inserting or removing it into this terminal.
- Always keep the IC portion of the UIM clean.
- Clean the UIM with a soft, dry cloth (Lens cleaning cloth).
- Be sure to keep a separate note of the information registered to this terminal.  
DOCOMO assumes no responsibility for the loss of any of your data.
- Visit docomo Shop to return the UIM for the environmental purpose.
- Do not scratch, touch carelessly or short circuit the IC portion.  
Data loss or malfunction may result.
- Do not drop or give shock to the UIM .  
Malfunction may result.
- Do not bend or put heavy things on the UIM.  
Malfunction may result.
- Do not insert UIM into this terminal with labels or stickers attached on.  
Malfunction may result.



## CAUTION

- **Do not use the modified this terminal. Using modified this terminal result in violating the law of Electromagnetic Compatibility.**

This terminal has been complied with technical standard of wireless equipment stipulated by law of Electromagnetic Compatibility. As a proof, "Technical standard compliance mark  " is indicated in the inscription seal. If this terminal is modified by turning the screw to the left to disassemble, technical standard compliance becomes invalid.

Please do not use this terminal during the time when technical standard compliance is being invalid, since you are in violation of the law of Electromagnetic Compatibility.

- **Keep this terminal 5mm or more away from your body while communicating.**

## Basic Package

- L-02C Terminal (With Front Cover L01, Back Cover L20 and Warranty)

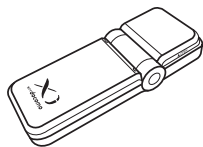

- L-02C INSTRUCTION MANUAL~Connection Guide~

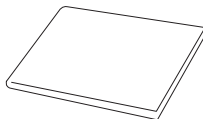

- L-02C CD-ROM

- L-02C Connection Software (For Windows/ Macintosh)
- L-02C APN Setting Tool (For Windows)
- L-02C INSTRUCTION MANUAL (PDF)

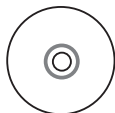

※Software specifications are subject to change without prior notice.

- Carrying Case (Sample)

Put this terminal into the carrying case when not in use or carrying it.

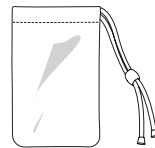

- USB Extension Cable (Sample)

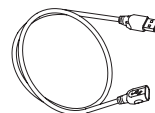

- Mounting Holder (Sample)

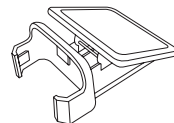

# Before Using this Terminal

Names of Parts and Functions .....	18
Using UIM .....	19
Available Communications .....	23
Connecting this Terminal to a PC .....	24

## Names of Parts and Functions

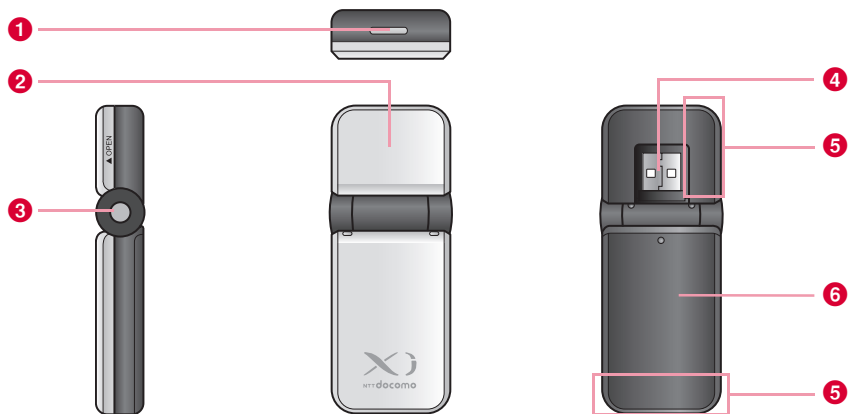

**1 Communication Status Lamp→P19**

Indicates status of this terminal

**2 Front Cover L01**

The part for inserting front cover L01 is called front part.

**3 PWR Lamp→P19**

Indicates the power supply conditions

**4 USB Connector**

A connection terminal used to connect with PC

**5 Antenna Part**

The antenna is inside this terminal.

**6 Back Cover L20**

The part for inserting back cover L20 is called back part.

## Mode Indication Lamp

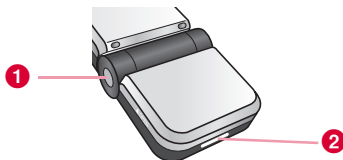

Status		①PWR Lamp	②Status Lamp
Power ON		White	-
While communicating	LTE	White	Blue
	W-CDMA(3G)	White	Magenta
	HSDPA	White	Cyan
	HSUPA	White	Cyan
	GPRS	White	Green
During packet communication (with no sent or received data)*		White	Blue-white
Out of service		White	Yellow
PIN 1	PIN1 Lock	White	Red
	Waiting to unlock PIN1	White	Red

\* A long period with no sent or received data.

## Using UIM

A UIM is an IC card that stores personal information such as your phone number. Without the UIM installed in this terminal, you cannot use data communication. For detailed information, refer to UIM Manual.

UIM cannot be used in this terminal. Exchange your UIM at a docomo Shop.

## Inserting/Removing

### Inserting

Inserting a UIM with both hands.

- Slide the front cover LO1 in direction ①, lift the cover as shown by ②

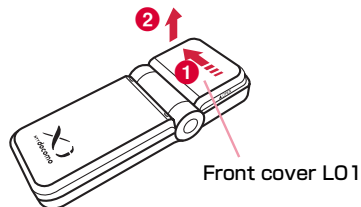

- 2** Insert a UIM into the slot guide in the direction of arrow with the IC chip side down

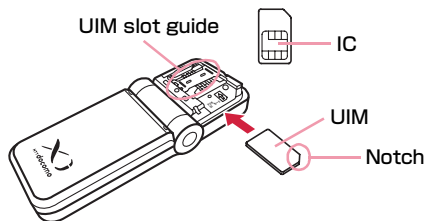

- 3** Fit the front cover LO1 to the ditch of this terminal at approximately 1 to 2mm. While pushing in the direction of ①, slide the back cover in the direction of ② till hear back cover clicked

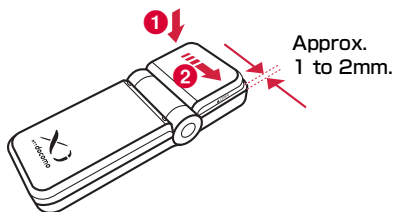

## Removing

Remove a UIM with both hands.

- 1** Slide the front cover LO1 in direction ①, lift the cover as shown by ②

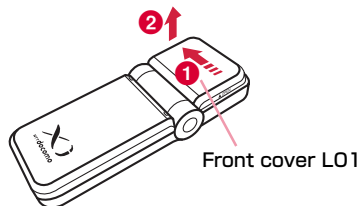

- 2** Hook your finger tip over the groove of UIM slot, slide in the direction of arrow and remove the UIM

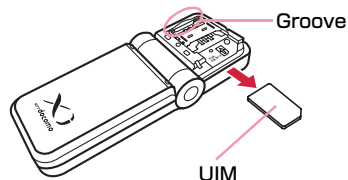

- 3** Fit the front cover LO1 to the ditch of this terminal at approximately 1 to 2mm. While pushing in the direction of **1**, slide the back cover in the direction of **2** till hear back cover clicked

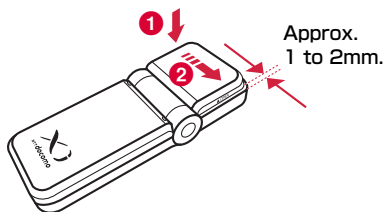

#### Note

- Do not lose the removed UIM.
- Make sure to both sides of the UIM.

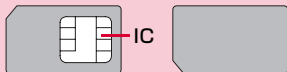

- Be careful not to scratch the UIM IC tip.
- Inserting a UIM in the reversed direction may cause malfunction.
- Inserting or removing the UIM with an excessive force may cause damage to your UIM.
- Do not remove the UIM while this terminal is inserted to a PC, it may cause damage to your UIM.

## Security Code

You can set PIN1 code (Personal Identification Number) for UIM. The default setting for the PIN1 code is "0000". The PIN1 code is a 4 to 8-digit security code to be entered every time this terminal is turned on for user verification to prevent any unauthorized use by others.

If your UIM is set to require a PIN1 code, data communication cannot be performed until the PIN1 code is entered. Use UIM before verifying the PIN1 code, or set (→P58) UIM to not verify the PIN1 code in advance.

### ■ Changing PIN1 Code

You can change the PIN1 code to any number. To prevent any unauthorized use by third parties, change it to your own number. If you improperly enter the PIN1 code 3 times in a row, further entry is locked automatically (PIN1 Lock), so be sure to keep a separate note of the numbers you set.

- Changing PIN1 Code. (→P59)

### ■ Unlocking PIN Code

The unblocking PIN code is the number in 8 digits used to unblock the PIN1 code. Details are written in the application of the contract (a duplicate copy) during the subscription. You are notified of your unblocking PIN code when purchase this terminal. If you improperly enter the unblocking PIN code for 10 times in a row, the UIM locks automatically.

### Caution

- Do not set PIN1 code to numbers that can easily make a guess, such as "birth date", "part of your phone number", "numbers from address or room number", "1111" "1234", etc. Also memo your PIN1 code and keep it well.
- Keep your PIN1 code away from being known by other people. DOCOMO assumes no responsibility for the loss of any of your data results from abuse of PIN1 code.
- If you forgot your PIN1 code, you (if you are the covenanter) are required to bring your ID (driving license, etc.) and UIM to a docomo shop. For details, please contact "docomo Information Center" on the back cover of this manual.
- Unblocking PIN code is written on the proposal form handed in at time of contract in docomo shop. For covenanter who signed the contract other than docomo shop are required to bring your ID (driving license, etc.) and UIM to a docomo shop, or contact "docomo Information Center" on the back cover of this manual.

Activate L-02C Connection Software  
PIN1 code Verification screen appears



Enter PIN1 Code

Incorrect entry 3 times in a row



Enter Unblocking PIN Code

OK

Incorrect entry 10 times in a row



Available to set a new  
PIN1 code



Contact a docomo Shop



## Available Communications

### Xi Data Communication/FOMA Packet Communication

Fees for this communication method are based on the amount of exchanged data. You can perform data communication at a speed of up to 37.5Mbps for receiving data and up to 12.5Mbps for sending data (Part of the indoor facilities within Xi area can reach the speed of up to 75Mbps for receiving data and up to 25Mbps for sending data) by using a connection that allows Xi data communication or FOMA packet communication such as "mopera U", one of DOCOMO's Internet connection services.

- ※ Communication speed is theoretical values when sending and receiving data which does not show the actual ones. The actual communication speed depends on communication environment and network congestion.
- DOCOMO offers Internet connection services, such as "mopera U". For details, visit the mopera U website. <http://www.mopera.net/> (Japanese only)
- Depending on bandwidth, communication speed for receiving is theoretically 100/100/75/37.5Mbps (with bandwidth of [20/15/10/5MHz]), and for sending is 50/37.5/25/12.5Mbps (with bandwidth of [20/15/10/5MHz]).
- For the FOMA HIGH-SPEED areas outside Xi area, the maximum speed for receiving data is 7.2Mbps and for sending is 5.7Mbps.

- Sending and receiving data become 384kbps in FOMA area out of Xi area and FOMA HIGH-SPEED area.
- The communication speed varies depending on the access point and radio wave status.
- The communication speed varies depending on the overseas carrier or network when using overseas.

#### Note

- Communication fees become high when performing communications with large amount of data such as browsing websites with many graphics or downloading data.
- Data communication may take more time or become difficult to connect depending on the network congestion. For customers who use a large amount of data communication (Approximate 380MBytes data or more is used within the last three days including the current day), it may have difficulties in sending and receiving data on time. Also, data communication may get disconnected in the following cases such as when a large amount of data communication occurs at a time or within a certain period of time, when being connected for a long time, or when connecting several times in a row within a certain period of time.
- This terminal does not support 64K data communication.
- This terminal does not support Remote Wakeup.
- This terminal does not support FAX communication.

## Usage Notes

### ■ Internet service provider (ISP) fees

Fees to an ISP may be required to connect to the Internet. These fees are added to the Xi service fees and are paid to your ISP directly. For details on connection fees, contact your ISP.

You can subscribe to such as "mopera U", one of DOCOMO's Internet connection services. Charge for subscribing "mopera U" is required.

For service and connection settings of "mopera U", visit the "mopera U" website.

<http://www.mopera.net/> (Japanese only)

### ■ User authentication to access networks

Depending on the access point, user authentication (ID and password) may be required to connect. If required, enter the ID and password from communication software or dial-up network. The ID and password will be provided by the network administrator of your ISP or the access point. For details, contact your provider or access point network administrator.

### ■ Requirements for communication

The following conditions must be met to perform communications using this terminal. However, a connection may not be established if traffic is heavy at the base station or if radio signals are weak.

- This terminal must be in Xi network, FOMA network or DOCOMO's roaming service area.
- The access point corresponds to the Xi data communication or FOMA packet communication.

## Connecting this Terminal to a PC

When connecting this terminal with a PC for the first time, it is required to install L-02C connection software (including a driver). For installing L-02C connection software, refer to the following.

- For Windows: "Preparation for using L-02C" (→P34)
- For Macintosh: "Preparation for using L-02C" (→P43)

## Inserting

**1** Turn on a PC

**2** Connect this terminal with a PC

■ When using the mounting holder (Sample) and the USB extension cable (Sample)

- Use the mounting holder and the USB extension cable to fix the terminal on the PC

① Lift the front part as the following

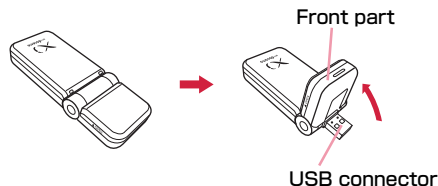

- 2 Hold the connector part of the USB extension cable and insert into the USB connector of this terminal in direction of arrow

\* Firmly insert into the USB connector.

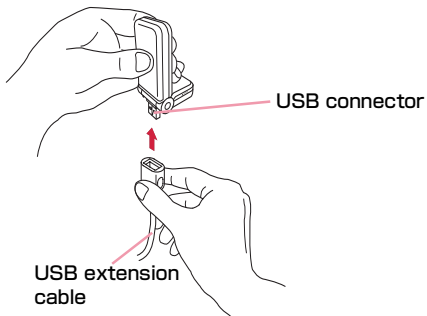

- 3 Fix the mounting holder into this terminal

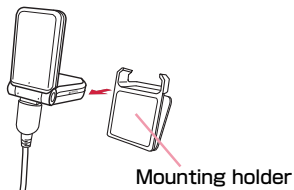

- 4 Fix the mounting holder on the top part of PC

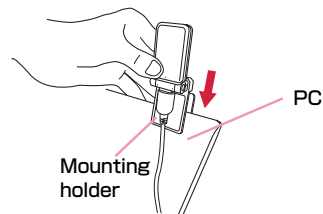

- 5 Hold the connector part of the USB cable and insert it into PC USB port in direction of arrow with inscription of the USB side up

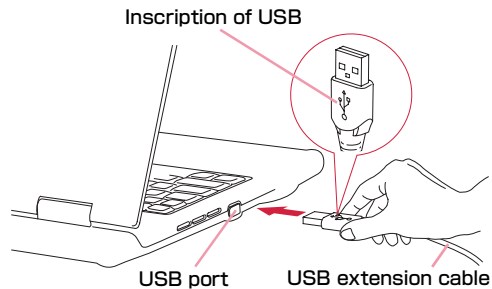

### ■ When connecting with a PC directly

- Insert this terminal into a PC USB port and use it directly.

#### ❶ Lift the front part as the following

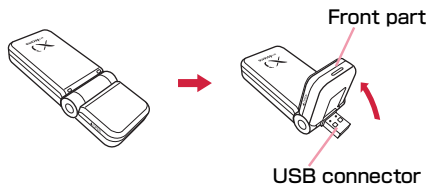

#### ❷ Insert the USB connector of this terminal into the PC USB port

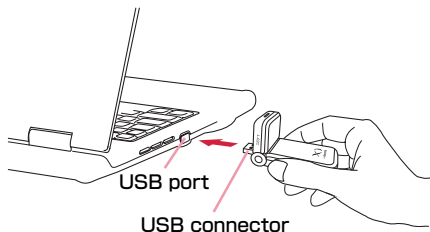

\* Malfunction or damage may result when subject this terminal to severe shocks due to carelessness.

### 3 Start communication connection

- Using "L-02C connection software" (→P51)
- Using "Mobile Broadband" (→P63)
- Configuring manually (→P69)

#### Note

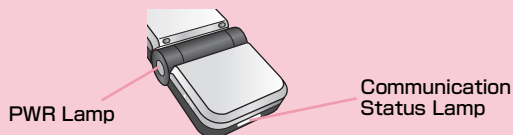

- Check if the color of PWR lamp is white while attempting to connect communication and the color of Communication Status Lamp is blue, magenta, cyan or green.
- The message of "さらに高速で実行できるデバイス(The device that can run in high speed)" may be displayed on the task tray when inserting this terminal into the PC. Available to use without changing the settings.
- Keep the PC away from entering conditions such as sleep (standby) or power off. Operations may become abnormal. In that case, remove this terminal first before the PC turns to sleep (standby) or power off.

## Removing

### 1 Disconnect data communication

If the L-02C connection software is running, or L-02C APN setting tool is running, close it first. Make sure the data connection is disconnected.

### 2 Remove this terminal

■ When using the mounting holder (Sample) and the USB extension cable (Sample)

- 1 Hold the connector part of the USB extension cable and pull out this terminal from PC USB port in direction of arrow

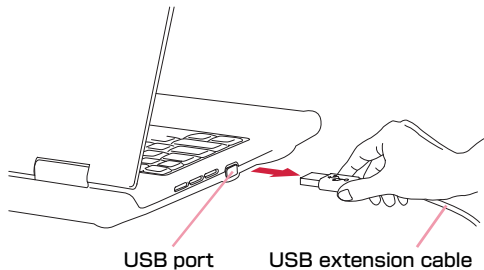

- 2 Remove this terminal along with the mounting holder from the top of the PC.

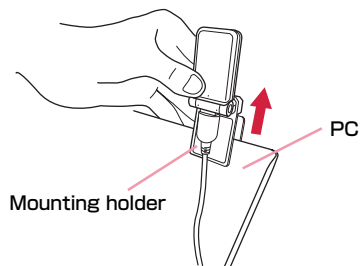

- 3 Remove this terminal from the mounting holder

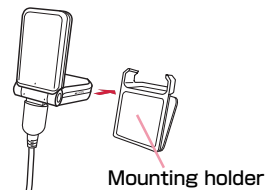

- 4 Hold the connector part of the USB extension cable and pull out from the USB connector in direction of arrow

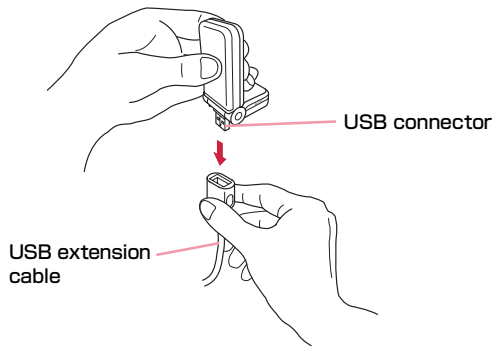

- 5 Stretch the front part as the following

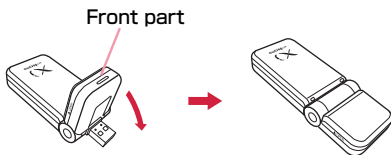

- When connecting to a PC directly

- 1 Hold the USB connector part of this terminal and pull out this terminal straightly from PC USB port

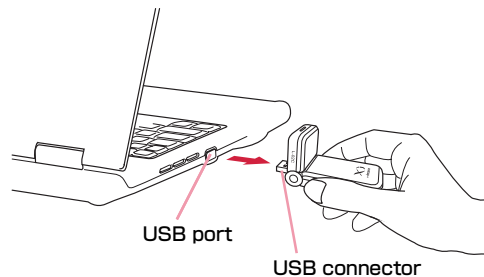

- 2 Stretch the front part as the following

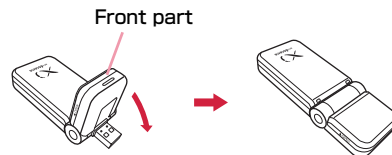

### Caution

- If you force to remove this terminal or pull out the USB connector, malfunction may result.
- Removing this terminal from the PC during data communication may suspend data communication and result malfunction or data losses.

# Setting Up

Setting Up .....	30
Windows Version .....	33
Macintosh Version .....	43

## Setting Up

### ■ Data communication via L-02C

"Communication configuration file (Driver)" is required to install on a PC to recognize this terminal.

In L-02C Setup, not only "Communication configuration file (Driver)", the data communication software of "L-02C connection software" and "L-02C APN setting tool" (Windows only) will be installed as well.

Data communication is available with only L-02C connection software, if necessary using Mobile Broadband (Windows 7 only) is also available.

For PC with Windows OS in it, data communication is also available based on configuring manually after installing L-02C connection software.

### ■ Installation of L-02C connection software

Since L-02C has zero installation, when connecting this terminal to a PC for the first time, "L-02C connection software" installation screen appears automatically. "Zero installation" is supported by PC with Windows OS in it. Even if zero installation works improperly, L-02C connection software and L-02C APN setting tool (Windows only) can be installed via the included CD-ROM.

In addition, although Macintosh does not support the zero installation feature, installation continues when click the CD-ROM icon appears when connecting this terminal to a PC.

The procedure of setting up is described on the next page.



## Work Flow of Setting Up

Connecting this terminal with a PC

- Windows Version▶P34
- Macintosh Version▶P43

Preparing the included CD-ROM

- Windows Version▶P38
- Macintosh Version▶P46

Installing L-02C connection software (including a driver), L-02C APN setting tool (Windows only)

Confirmation after Setup

- Windows Version▶P39/ • Macintosh Version▶P46

Using L-02C  
connection  
software

Environment configurations  
of L-02C connection  
software▶P56

Communication connection  
via L-02C connection  
software▶P52

Using Mobile  
Broadband of  
Windows 7

Communication connection  
through Mobile Broadband  
▶P65

Configuring  
manually

Configuring Communication manually  
• Windows Version ▶P70

Configuring Communication manually via OS  
• Windows Version▶P86

## Operating Environments

Using this terminal under the following operational environments.

Item	Requirement
PC Main Unit	<ul style="list-style-type: none"><li>• Available to use CD-ROM drive on PC/AT and Mac compatible.</li><li>• USB port (standard of Universal Serial Bus Specification Rev2.0)</li><li>• Operations via USB hub (including USB port on monitor and keyboard) cannot be guaranteed.</li><li>• Display resolution of 800×600 pixels, 16-bit Color (65,536) or higher is recommended.</li></ul>
OS*1	Windows XP SP3 or later (Japanese version) Windows Vista SP2 or later (Japanese version) Windows 7 (Japanese version) Mac OS X 10.5.8 (32bit Japanese version)*2 Mac OS X 10.6.4 (32bit Japanese version)*2
Required Memory*3	Windows XP: 256Mbytes or more Windows Vista: 512Mbytes or more Windows 7: 1Gbytes or more(32bit) Windows 7: 1Gbytes or more (64bit) Mac OS X 10.5.8: 512Mbytes or more Mac OS X 10.6.4: 1Gbytes or more
Hard Disk Space*3	50Mbytes or more available space

※1 DOCOMO does not guarantee the operation under the supported OS of the OS is changed through update.

※2 Only Mac with CPU made by Intel Corporation is available.

※3 Required memory or available hard disk space may vary depending on the system environment of a PC.

For latest information of operation environment, visit DOCOMO's "international website"

### Note

- The software may not work depending on your operating system environment and type of machine. DOCOMO does not guarantee any operation other than the operation environment described in the Table on the left side.

## Windows Version

Installation of L-02C connection software is only required when connect this terminal to your PC for the first time.

※The following procedures or screen images are all based on the example of Windows 7.

### Note

- When installing, insert this terminal into USB port after OS is activated.
- DO not insert the CD-ROM into CD drive when zero installation (Auto) starts.
- Do not remove this terminal while installing.
- Installation may take several minutes depending on the PC.
- Do not install or uninstall during data communication.
- End all the applications before installing. Also end programs on Windows including virus check software.
- When installing, make sure to install from the account with PC supervisor privileges. An error will occur during installation if you install from the account without privileges.
- For details on setting up PC supervisor privileges, contact your computer manufacturer or Microsoft Corporation.

### ■ Notes when CD/DVD playback and written software are being installed into a PC

In some PCs, this terminal may not be recognized normally depending on the playback of the installed CD/DVD and the version of the written application software even if this terminal is connected when the application software residents\* or during being activated.

Refer to "Troubleshooting" for proper solutions. (→P113)

※The software under the state of icons being displayed on task tray is also included.

## Preparation before Using L-02C

### Setting Zero Installation (Auto)

1 Turn on a PC and activate OS

2 Connect this terminal with the PC

The setup screen of L-02C connection software is automatically displayed by zero installation.

"自動再生(Auto play)" screen will be displayed depending on settings. If the screen is displayed, check "ソフトウェアとゲームに対しては常に次の動作を行う(Always operates for software and game)" and select "L02CLauncher.exeの実行(Execute L02CLauncher.exe)".

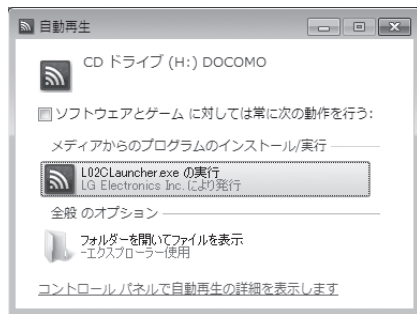

- When the setup screen of L-02C connection software is not automatically displayed, install via the included CD-ROM. (→P38)

3 Select "L-02C 接続ソフト、L-02C 接続先(APN) 設定ツール、通信設定ファイル(ドライバ)をインストールする(推奨)(L-02C connection software, L-02C APN setting tool, Communication configuration file (driver) (recommended))" and click "次へ(Next)"

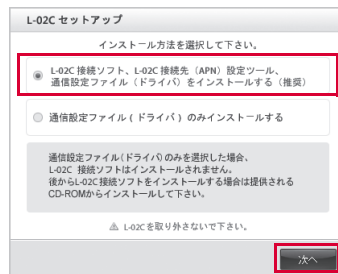

■ Install the communication configuration file (Driver) only

- Select "通信設定ファイル(ドライバ)のみインストールする (Install communication configuration file (Driver) only)" and click "次へ(Next)"
- Click "はい(Yes)" on "ユーザー アカウント制御(User account control)" screen
  - For Windows Vista
    - Click "続行(Continue)" on "ユーザー アカウント制御 (User account control)" screen
  - For Windows XP
    - "ユーザーアカウント制御 (User account control)" screen is not displayed, follow the next procedure.
- Confirm the content of "使用許諾契約(The license agreement)", check "使用許諾契約の全条項に同意します。(I have read all the stipulations of this license agreement and I agree.)" and click "次へ(Next)"
- Click "次へ(Next)"
- Click "OK"

- ⑥ Confirm that this terminal is recognized by PC
- ⑦ Confirm the settings of driver following "インストールしたL-O2C 通信設定ファイル(ドライバ)を確認する(Confirm the installed L-O2C communication configuration file (Driver))" (→P39)

#### 4 Click "はい(Yes)" on "ユーザー アカウント制御 (User account control)" screen

##### ■ For Windows Vista

- Click "続行(Continue)" on "ユーザー アカウント制御 (User account control)" screen

##### ■ For Windows XP

- "ユーザー アカウント制御(User account control)" screen is not displayed. Follow the next step.

#### 5 Click "次へ(NEXT)"

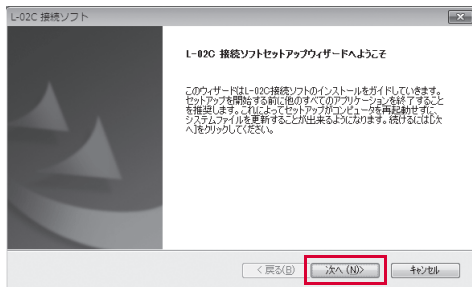

#### 6 Confirm the contents of "使用許諾契約(The license agreement)". When agree with the contents, select "使用許諾契約の全条項に同意します(I agree with all the license agreement stipulations)" and click "次へ(NEXT)"

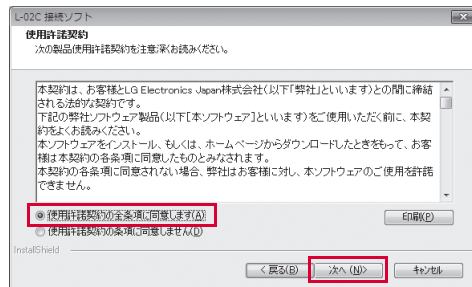

Installation starts.

## 7 Click "完了(Finish)"

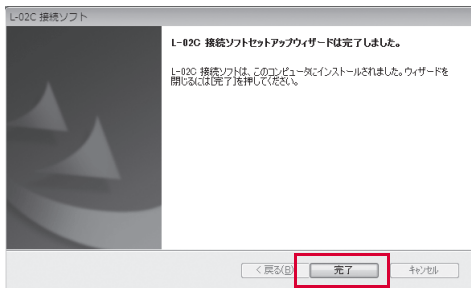

### ■ For Windows XP

- If use W-TCP function (recommended), make sure that "W-TCP機能を使用する (推奨) (Use WTCP function (recommended))" has the check mark and click "完了 (Finish)".

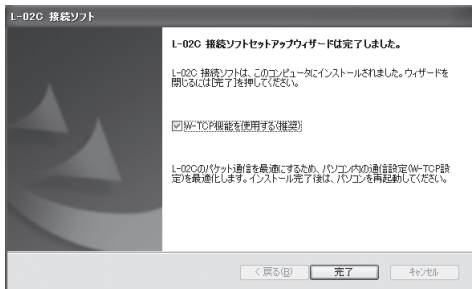

Installation of L-02C communication configuration file (Driver) continues.

※ It may take time to move to the next procedure depending on your PC.

## 8 Confirm whether this terminal is recognized by the PC

On the lower right side of task tray, "デバイスドライバソフトウェアをインストールしています (Device driver software is being installed)" appears, and this terminal is recognized automatically.

※ To recognize this terminal automatically, "L-02Cが取り外されました(L-02C is disconnected)" may appear on L-02C connection software temporarily. After a while, this terminal will be recognized.

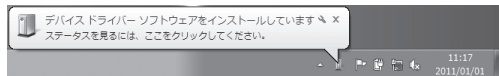

If this terminal is recognized properly, "デバイスを使用する準備ができました(The device is ready for use)" will appear.



### ■ For Windows Vista

- On the bottom right of task bar, a message of "デバイスドライバソフトウェアをインストールしています (Device driver software is being installed)" appears, this terminal will be recognized automatically.

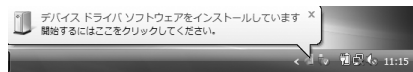

- If this terminal is recognized normally, a message of "デバイスを使用する準備ができました (Ready to use the device)" will appear.

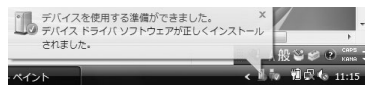

## ■ For Windows XP

- On the lower right side of task tray, "新しいハードウェアが見つかりました (A new hardware has been found.);" appears, and this terminal is recognized automatically.

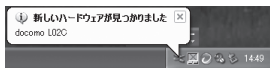

- If this terminal is recognized properly, "新しいハードウェアがインストールされ、使用準備ができました。(A new hardware has been installed and ready for use.);" will appear.

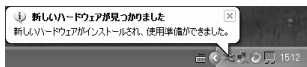

## 9 Install Flash Player

A message appears if Flash Player is not installed in your PC. Install Flash Player by the following procedures.

### 1 Click "OK"



- Click "はい(Yes)" on "ユーザー アカウント制御(User account control)" screen  
Installation of Flash Player starts.

## ■ For Windows Vista

- Click "続行(Continue)" on "ユーザーアカウント制御 (User account control)" screen.

## ■ For Windows XP

- "ユーザーアカウント制御 (User account control)" screen is not displayed, move to the next procedure.

- 3 Read the content of "使用許諾契約(License agreement)", check "使用許諾契約の条件を読み、同意しました。(I agree with the license agreement stipulations)" and click "インストール(Install)"

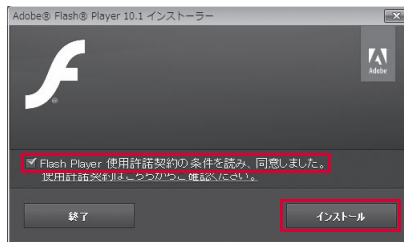

- 4 Click "完了(Finish)"

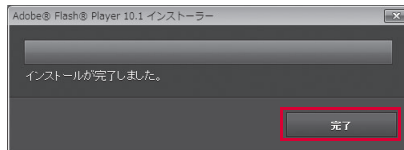

Installation finishes.

If "W-TCP機能を使用する (推奨) (Use W-TCP function (recommended))" has the check mark, restart the PC after installation.

### 1 After starting a PC ▶ Insert the included CD-ROM into the PC

"自動再生(Auto play)" screen will appear depending on setting. Select "フォルダーを開いてファイルを表示(Open a folder to display files)".



### 2 Select "Windows" inside the CD-ROM ▶ "L-02C 接続ソフト、L-02C 接続先(APN)設定ツール (L-02C connection software, L-02C APN setting tool)" ▶ "LGCM\_02C\_v1.0.0.0J.exe"

#### ■ Install the communication configuration file (Driver) only

- ① Select "Windows" inside the CD-ROM ▶ "Driver" ▶ "docomo\_L02C\_ModemDriver\_WHQL\_Ver\_1.6\_All.exe"
- ② Click "はい(Yes)" on "ユーザー アカウント制御(User account control)" screen

#### ■ For Windows Vista

- Click "続行(Continue)" on "ユーザー アカウント制御 (User account control)" screen

#### ■ For Windows XP

- "ユーザーアカウント制御 (User account control)" screen is not displayed, follow the next procedure.

- ③ Confirm the content of "使用許諾契約(The license agreement)", check "使用許諾契約の全条項に同意します。(I have read all the stipulations of this license agreement and I agree.)" and click "次へ(Next)"
- ④ Click "次へ(Next)"
- ⑤ Click "OK"
- ⑥ Connect this terminal to the PC
- ⑦ Confirm that this terminal is recognized by PC
- ⑧ Confirm the settings of driver following "Confirm the installed L-02C communication configuration file (Driver)". (→P39)

### 3 For subsequent steps, operate the same procedures as those after procedure 4 in "Setting Zero Installation (Auto)"(→P35)

※ Connect this terminal to the PC after clicking "完了(Finish)" in procedure 7.

"自動再生(Auto play)" screen will be displayed depending on the settings. If the screen is displayed, check "ソフトウェアとゲームに対しては常に次の動作を行う(Always operates for software and game)" and select "L02CLauncher.exeの実行(Execute L02CLauncher.exe)". This terminal will be recognized by the PC.



## Confirming after Installation

### Confirming L-02C Connection Software

#### 1 Double click L-02C connection software icon displayed on the desktop

When the following screen is displayed, the confirmation of installation finishes.



#### Note

- For Windows 7, L-02C connection software cannot be activated due to the setting of mobile broadband auto connection. Set to "自動的に接続しない(Do not connect automatically)". →P65

## Confirming the Installed L-02C Communication Configuration File (Drivers)

Confirm whether L-02C Communication Configuration File (Drivers) is set in a PC.

#### 1 Click "スタート(Start)" ▶ "コントロールパネル (Control panel)" ▶ "システムとセキュリティ (System and security)"

##### ■ For Windows Vista

- Click "スタート(Start)" ▶ "コントロールパネル(Control panel)" ▶ "システムとメンテナンス(System and maintenance)"

##### ■ For Windows XP

- Click "スタート(Start)" ▶ "コントロールパネル(Control panel)" ▶ "パフォーマンスとメンテナンス(Performance and maintenance)" ▶ "システム(System)"

#### 2 Click "デバイス マネージャー (Device manager)"

##### ■ For Windows Vista

- Click "デバイス マネージャ (Device manager)" ▶ "続行 (Continue)"

##### ■ For Windows XP

- Click "ハードウェア(Hardware)" tab ▶ "デバイス マネージャ (Device manager)"

### 3 Click each device display to confirm the driver name installed

- Confirm whether the driver name is displayed below "ネットワーク アダプター (Network adapter)", "ポート(COM と LPT)(Port (COM and LPT))", "モデム (Modem)", "ユニバーサル シリアス バス コントローラー (Universal Serial Bus Controller)"

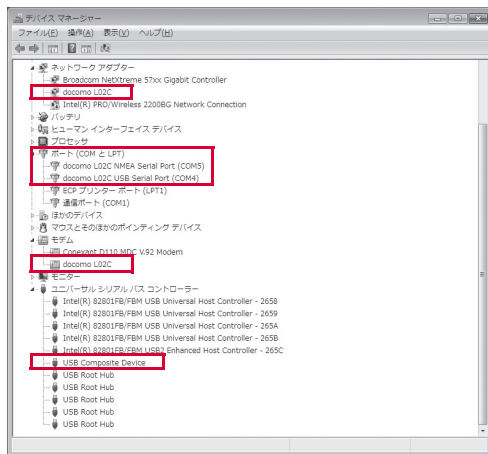

- COM port number differs depending on user and PC.

OS	Device name	Driver name
Windows 7	Network Adapter	docomo L02C
	Port (COM and LPT)	docomo L02C NMEA Serial Port docomo L02C USB Serial Port
	Modem	docomo L02C
	Universal Serial Bus Controller	USB Composite Device
Windows Vista	Network Adapter	docomo L02C
	Port (COM and LPT)	docomo L02C NMEA Serial Port docomo L02C USB Serial Port
	Modem	docomo L02C
	Universal Serial Bus Controller	USB 複合デバイス (USB Composite Device)
Windows XP	Network Adapter	docomo L02C
	Port (COM and LPT)	docomo L02C NMEA Serial Port docomo L02C USB Serial Port
	Modem	docomo L02C
	USB(Universal Serial Bus) Controller	USB 複合デバイス (USB Composite Device)

## Note

- After inserting this terminal into the PC USB port, if this terminal is not recognized, try with another USB port. Depending on PC, this terminal may not be recognized with certain USB port.
- When communicating data with L-02C connection software, application operation of L-02C connection software is required.→P56
- When using mobile broadband of Windows 7 to communicate data, set in mobile broadband. →P66
- When communicating data with neither L-02C connection software nor Mobile broadband of Windows 7, configure it manually.→P70

## Uninstalling L-02C Connection Software (including a driver)

- Before uninstalling, remove this terminal from the PC.
- When uninstalling, make sure to install from the account with PC supervisor privileges.

- 1 Click  "スタート(Start)" ▶ "すべてのプログラム (All programs)" ▶ "L-02C 接続ソフト(L-02C connection software)" ▶ "Uninstall L-02C 接続ソフト(Uninstall L-02C connection software)"

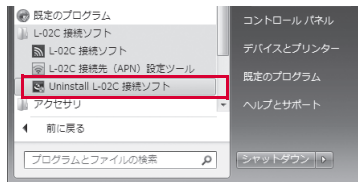

### ■ For Windows Vista

- Click  "スタート(Start)" ▶ "すべてのプログラム (All programs)" ▶ "L-02C 接続ソフト(L-02C connection software)" ▶ "Uninstall L-02C 接続ソフト(Uninstall L-02C connection software)".

### ■ For Windows XP

- Click "スタート(Start)" ▶ "すべてのプログラム (All programs)" ▶ "L-02C 接続ソフト(L-02C connection software)" ▶ "Uninstall L-02C 接続ソフト(Uninstall L-02C connection software)".

## 2 Click "はい(Yes)" on "ユーザーアカウント制御 (User account control)" screen

Click "いいえ(No)" to stop uninstalling.

### ■ For Windows Vista

- Click "続行(Continue)" on "ユーザー アカウント制御 (User account control)" screen

### ■ For Windows XP

- "ユーザーアカウント制御 (User account control)" screen is not displayed, follow the next procedure.

## 3 Click "OK" on "ファイル削除の確認 (Confirmation of deleting files)" screen

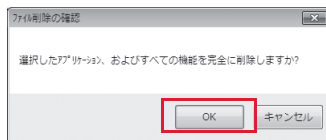

## 4 Click "はい(Yes)" on "[「ユーザーデータ削除の確認」(Confirming to delete user data)]" if user data is no more necessary.

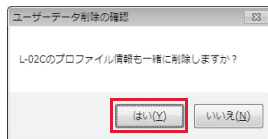

In case that "いいえ(No)" is clicked, user data will not be deleted.

- APN information and connection type(IPv4, IPv4/v6, IPv6) will not be deleted even if "はい(Yes)" is clicked.

## 5 Click "完了 (Finish)"

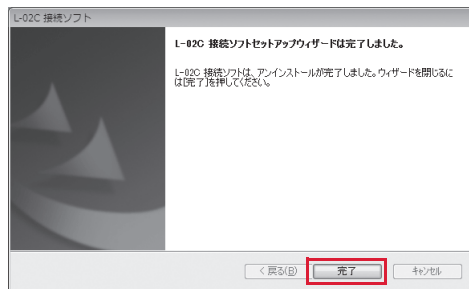

### ■ For Windows XP

- Make sure that "W-TCP機能の最適化を解除する (推奨 (Cancel optimization of W-TCP function (recommended)))" has the check mark and click "完了 (Finish)".

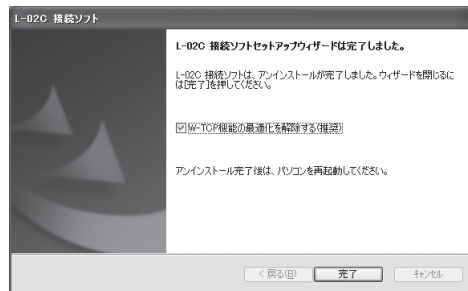

Uninstallation finishes.

- Restart your PC after uninstalling.

## Macintosh Version

Installation of L-02C connection software is only required to install when connect this terminal to your PC for the first time.

※ The following images are the examples of "Mac OS X 10.6".  
Images may differ for "Mac OS X 10.5".

### Note

- When installing, insert this terminal into USB port after OS is activated.
- Do not insert the CD-ROM into CD drive when installation via this terminal starts.
- Do not remove this terminal while installing.
- End all the applications before installing. Also end programs on Macintosh including virus check software.
- When installing, make sure to install from the account with PC supervisor privileges.

## Preparation before Using L-02C

### Setting via this Terminal

- 1 Turn on the PC and activate OS
- 2 Connect this terminal with the PC  
CD-ROM icon is displayed on the desktop.
- 3 Double click the CD-ROM icon
- 4 Double click "L-02C 接続ソフト インストーラー.pkg (L-02C connection software installer.pkg)"

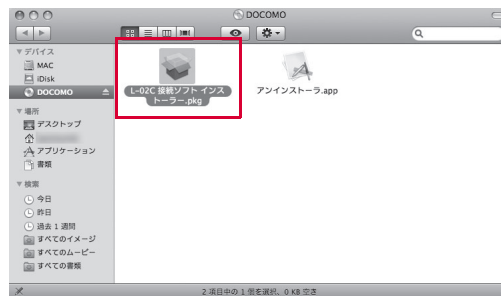

## 5 Click "続ける (Continue)"



## 6 Click "続ける (Continue)"

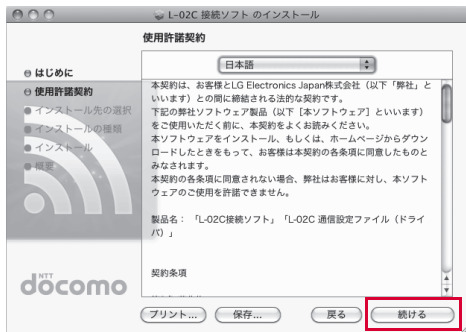

## 7 Confirm "使用許諾契約 (The license agreement)". If agree with the contents, click "同意する (I Agree)"



## 8 Select an installation destination, click "続ける (Continue)"



## 9 Click "インストール (Install)"



## 10 Enter administrator password ▶ Click "OK"

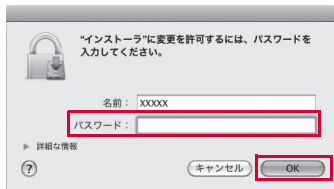

## 11 Click "インストールを続ける (Continue installing)"



## 12 Click "再起動 (Restart)"



The PC restarts. Installation finishes.  
Remove this terminal from the PC temporarily.

## Setting via CD-ROM

- 1 Start a PC ▶ Insert the CD-ROM into the PC  
CD-ROM icon on desktop appears.
- 2 Double click CD-ROM icon ▶ "Mac" ▶ "L-02C  
接続ソフト(L-02C connection software)" in the  
order
- 3 For subsequent steps, operate the same  
procedures as those after procedure 4 in  
"Setting by this terminal" (→P43)  
※ Connect this terminal to the PC after restarting the PC in  
procedure 12.

## Confirming after Installation

### Confirming L-02C Connection Software

- 1 Connect this terminal with the PC
- 2 Drag the CD image (DOCOMO icon) displayed  
on desktop into trash bin  
This terminal will be recognized as a modem.
- 3 Click "'ネットワーク環境設定('Network'  
environment configuration)'"





#### 4 Select "docomo L02C" and click "適用 (Apply)"



#### 5 Close "ネットワーク (Network)" screen

#### 6 Double click to launch "Finder" ▶ "アプリケーション (Application)" ▶ "L-02C 接続ソフト.app (L-02C connection software.app)"

When the following screen is displayed, the confirmation of installation finishes.



## ■ Install Flash Player

A message appears when activating the L-02C connection software for the first time if Flash Player is not installed in your PC. Install Flash Player following the procedures below.

1 Double click to launch "Finder" ▶ "アプリケーション (Application)" ▶ "L-02C 接続ソフト.app (L-02C connection software.app)"

2 Click "OK"

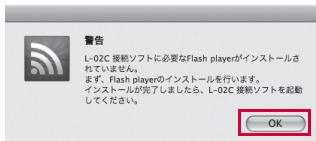

3 Confirm the content of "使用許諾契約(The license agreement)", check "使用許諾契約の条件を読み、同意しました。(I have read the stipulations of this license agreement and I agreed.)" and click "インストール (Install)"



4 Enter administrator password ▶ Click "OK"



5 Click "完了(Finish)"



Installation finishes.

## Note

- When communicating data via L-02C connection software, setting environment configuration of L-02C connection software is required.→P56

## Uninstalling L-02C Connection Software (including a driver)

- Before uninstalling, remove this terminal from the PC.
- When uninstalling, make sure to install from the account with PC supervisor privileges.

- 1 Insert the included CD-ROM into a PC  
CD-ROM icon is displayed on the desktop.
- 2 Double click the CD-ROM icon ▶ "Mac"  
▶ "L-02C 接続ソフト(L-02C connection software)"
- 3 Double click "アンインストーラ.app (Uninstaller.app)"



- 4 Click "アンインストール(Uninstall)"

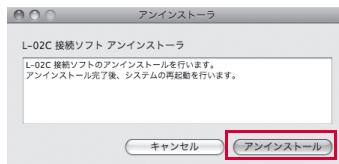

- 5 Enter administrator password ▶ Click "OK"

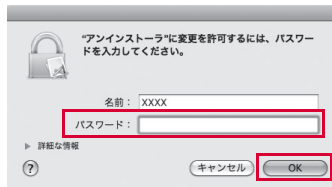

- 6 Make sure this terminal is not connected to the USB port before restarting

- 7 Click "再起動(Restart)"



The PC restarts. Uninstallation finishes.



# L-02C Connection Software

L-02C Connection Software .....	52
Using Packet Communication .....	54
Environment Configuration .....	56

L-02C connection software is available to use on either Windows or Macintosh. Despite the display images of Windows version and Macintosh version may differ, icons on screen and available functions are the same. Please note that in this chapter the descriptions are based on screen images of Windows.

## L-02C Connection Software

The L-02C connection software allows you to use packet communication.

### • Using Packet Communication→P54

Available to use packet communication easily.

### • Environment Configuration→P56, P92

Available to confirm packet usage, set profile, PIN1 lock of UIM, reset this terminal and set network(Only during international roaming), etc.

### Note

- L-02C connection software cannot be activated while L-02C APN setting tool is being operated.
- "接続先 (APN) 名(APN name)" of L-02C connection software and "接続先 (APN) (APN)" of L-02C APN setting tool are not interlocked.
- For Windows 7, L-02C connection software cannot be activated due to the setting of mobile broadband auto connection. Set to "自動的に接続しない (Do not connect automatically)".
- If use L-02C connection software, do not connect with wired or wireless LAN.
- Packet communication via L-02C connection software is high speed NDIS type (similar to wireless LAN type). Dial up connection is also available. →P73  
Macintosh supports only NDIS type.
- L-02C connection software and dial up connection cannot be conducted at the same time.

## Launching and Exiting Connection Software (For Windows)

### Launching

- Activate automatically after connecting to this terminal.

### Exiting

- Click  displayed on the top of main screen.

## Launching and Exiting Connection Software (For Macintosh)

If connect a L-02C to a PC, the L-02C will be recognized as a CD-ROM first. Drag the CD-ROM icon into trash bin to have the L-02C recognized as a modem.

### Launching

- Launch "Finder" ▶ "アプリケーション(Application)" ▶ "L-02C 接続ソフト.app (L-02C connection software.app)"

### Exiting

- Menu bar ▶ "L-02C 接続ソフト(L-02C connection software)" ▶ "L-02C 接続ソフトを終了(Exit L-02C connection software)"

## Main Screen

### ■ Main screen while packet communicating

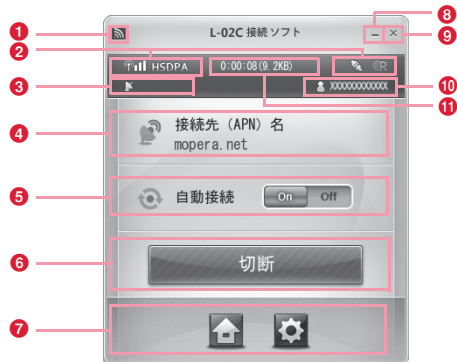

#### 1 Version information button

- Click to display version information of L-02C connection software.
- Checking and setting about the update of S/W version is conductable. (→P61)

#### 2 This terminal status area

	Signal bar
	Strong ← → Weak
	Not being connected*1/during packet communication (with no sent or received data)*2
	(Out of service) Out of service area/In the area with no signal

	Network type W-CDMA W-CDMA*3, HSDPA HSDPA*4, HSUPA HSUPA*4, LTE LTE*5, GPRS GPRS*6
	Packet communication While communicating While communicating (with no sent or received data)*2
	International roaming • This icon is displayed weakly in Japan.

- \*1 Antenna bars for showing receiving sensitivity are only displayed during packet communication.
- \*2 A long period with no sent or received data.
- \*3 W-CDMA (3G)  
A third generation mobile communication network complying with 3GPP Global standards. 3GPP means 3rd Generation Partnership Project. The local standardization organization established for the development of common technical specifications related to 3rd Generation Mobile Communication Systems (IMT-2000).
- \*4 HSDPA (Short for High Speed Downlink Packet Access) HSUPA (Short for High Speed Uplink Packet Access) A high speed type of W-CDMA data communication. It is called "3.5G" since it is the improvement version of 3rd generation (3G) cell phone (W-CDMA).
- \*5 "LTE" (short for Long Term Evolution) is a technology level between 3rd generation (3G) and 4th generation (4G) mobile phone. It is known as "3.9G".
- \*6 GPRS (Short for General Packet Radio Service) GPRS is the 2.5 generation mobile communication system that enables high speed packet communication using GSM.

#### 3 Carrier display area

- The name of the connected carrier is displayed if "オペレーター名表示設定(Operator name display)" is set to "表示する(Display)" (only while international roaming). (→P92)

#### 4 APN name area

- Current APN name is displayed.

#### 5 Internet auto connection On/Off switch



- When activating L-02C connection software, set auto internet connection.  
Drag switch to change On/Off.
- Auto connection is not available during international roaming.

#### 6 Connect/disconnect internet button

- Click to connect or disconnect internet.

#### 7 Operation buttons

- Buttons for main screen and settings are functioning.

	メイン画面 (Main screen) (→P53)
	環境設定 (Environment settings) (→P56)

#### 8 Minimize button

- A button residents on task tray in Windows.

#### 9 Quit button

- Exit L-02C connection software.

#### 10 Own phone number area

- Own phone number is displayed.

#### 11 Data communication information area

- Connection time and packet usage are displayed when internet is connected.

## Using Packet Communication

If auto connection is set to On in main screen, L-02C connection software is activated and packet communication is available after connecting this terminal to PC. In Macintosh, packet communication is available while auto connection is set to On in main screen after activating L-02C connection software.

- ※ Auto connection is set to On by default. After activating L-02C connection software, packet communication starts.

## Starting Packet Communication

### When Auto Connection is On

- Set auto connection to On beforehand.

### 1 Connect this terminal with a PC

- For Windows, L-02C connection software is activated automatically.  
For macintosh, activated L-02C connection software manually.
- Connection status icon , connection time and data usage are displayed in main screen.

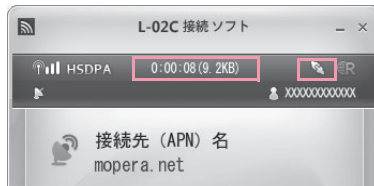



## When Auto Connection is Off



### 1 Connect this terminal with a PC

- For Windows, L-02C connection software is activated automatically.  
For Macintosh, activated L-02C connection software manually.

### 2 Click in main screen

- Connection status icon , connection time and data usage are displayed in main screen.

#### Note

- The default setting of APN is "mopera.net". Set "プロファイル設定(Profile settings)" to change APN. →P57
- A message of "接続が失敗しました。再実行しますか。(Failed in connecting. Do you want to try again?)" appears when connection fails. Check APN and connect again.
- If set the PC to sleep or stopping while packet being connected, packet communication may not be connected properly after retrieving. In that case, disconnect packet communication and remove the terminal from PC. Then set the PC to sleep or stopping condition.
- If click  with internet auto connection set to "On", it is not available to connect automatically. To execute packet communication again, click .
- For Macintosh, when L-02C NDIS device has not been registered, "docomo L-02Cネットワークサービスが確認できません。ネットワーク設定からdocomo L-02Cネットワークサービスを追加してください。(docomo L-02C network service cannot be recognized. Add docomo L-02C network service from Network configuration)" appears. Click "システム環境設定(System environment configuration)" ▶ "ネットワーク(Network)" from Apple menu, and then click "適用(Apply)". If click "OK", L-02C connection software exits. Try again.

## Disconnecting Packet Communication

### 1 Click in main screen

- Packet communication will be disconnected.

#### Note

- Clicking  does not turn off auto connection. Set auto connection to Off to not connect automatically.
- Packet communication may automatically be disconnected depending on the network condition or location.
- In packet communication, fees apply on the amount of sent/received data. Note that the communication fees may become high if you perform heavy communication such as browsing websites which include large multi-media contents or downloading a large size of data.
- For Windows 7, when L-02C connection software is ended, communication via mobile broadband starts depending on the auto connection setting of mobile broadband. To not connect automatically, set to "自動的に接続しない(Do not connect automatically)" in auto connection setting of mobile broadband. →P65

## Environment Configuration

Environment configuration screen appears if click  in main screen.

- Environment configuration screen is not displayed during packet communicating. Disconnect packet communication before setting environment configurations.



The following are required to connect Internet to L-02C connection software.

### 1 Profile settings

In "プロフィール設定(Profile settings)" screen, set "接続先 (APN) 名(APN name)", "ユーザー名(User name)", "パスワード (Password)", "認証方法(Authentication method)", "接続方式 (Connecting type)". (→P57)

Settings for overseas use such as roaming can be set in "ネットワーク設定(Network configuration)". (→P92)

## Confirming Packet Usage

- Check the amount of sending and receiving data.

### 1 Click "使用量(Packet usage)" in environment configuration screen

Packet usage is displayed.



#### 全体使用量(Total usage):

Accumulated total data usage

 : Reset total usage.

#### 今月の使用量(Usage for this month):

Usage from 1st of this month to current

 : Reset the usage of this month.

#### 前回の使用量 (Current usage):

Data usage of current session

 : Click to reset all the amount.

### Note

- The data usage displayed on the screen may differ from the actual volume of packet communication.

## Setting Profile

- Set basic items for packet communication.

- Click "プロフィール設定(Profile settings)" in environment configuration screen
- Start the following operations



### 接続先 (APN) 名 (APN name) :

The APN used when performing packet communication

### ユーザー名 (ID) : ID supplied by a service provider

### パスワード (Password) :

A password supplied by a service provider

### 認証方法 (Authentication method) :

An authentication method to enable to use this terminal

### 接続方式 (Connection type) :

Select an IP address acquisition method

- : Click to change settings.  
 : Click to return to default setting.

## 3 Click "設定(Set)"

A message to confirm is displayed.

## 4 Click "はい(Yes)"

## 5 Click "はい(Yes)"

### Note

- Click "設定(Set)" to renew the settings. Always remember to click when change settings.
- Internet can not be connected if ID or password is incorrect.
- Set the content of each profile according to the values specified by each provider or network administrator. Connection does not correctly perform with wrong settings.

## Setting a UIM

- Allows you to set "PIN1 ロック (PIN1 lock)", "PIN1 ロック解除 (PIN1 unblocking)", "PIN1 コード変更 (Change PIN1 code)"

- Click "[ドコモUIMカード]設定 ([UIM] settings)" in environment configuration screen

UIM settings screen is displayed.

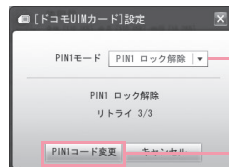

PIN1 mode

Change PIN1 code

## Locking PIN1

- Set security to UIM.

### 1 Select "PIN1 ロック (PIN1 Lock)" in PIN1 mode of UIM setting screen



Entering PIN1 code screen is displayed.

### 2 Enter the PIN1 code set in UIM



### 3 Click "OK"

### 4 Click "はい(Yes)"

#### Note

- When restarting L-02C connection software with PIN1 locked or after resetting this terminal, you need to enter PIN1 code from the screen of entering PIN1 code. This terminal can not be used properly unless correct PIN1 code is entered.

## Unlocking PIN1

### 1 Select "PIN1 ロック解除 (Cancel PIN1 Lock)" in PIN1 mode of UIM setting screen



Entering PIN1 code screen is displayed.

### 2 Enter the PIN1 code set in UIM



### 3 Click "OK"

### 4 Click "はい(Yes)"

#### Note

- If set to cancel PIN1 lock, you can use UIM information from this terminal without verifying PIN1 code.

## Changing PIN1 Code

- Set the password required when unlocking or locking PIN1.
- Changing PIN1 code is only available when PIN1 is locked.

### 1 Click "PIN1コード変更(Change PIN1 code)" in UIM setting screen

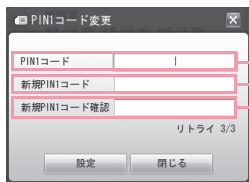

- Current PIN1 code
- PIN1 code to change
- Confirm PIN1 code to change

- 2 Enter the current PIN1 code set in UIM in "PIN1コード(PIN1 code)" field
- 3 Enter PIN1 code to change in "新規PIN1コード (New PIN1 code)"
- 4 In "新規PIN1コード確認(Confirm new PIN1 code)", enter the PIN1 code that has been entered in "新規PIN1コード (New PIN1 code)" code again
- 5 Click "設定(Set)"
- 6 Click "はい(Yes)"

## Entering PIN1 Code

- When L-02C connection software is started after setting PIN1 lock or it is restarted to reset this terminal, PIN1 code input screen will appear.

### 1 Enter PIN1 code

Enter the 4 to 8 digits PIN1 code.



### 2 Click "OK"

### 3 Confirm the result after entering PIN1 code

#### Ex.1 : When PIN1 code is entered correctly

Main screen of L-02C connection software is displayed.

#### Ex.2 : When PIN1 code is entered incorrectly

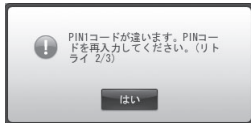

#### Ex.3 : When PIN1 code is entered incorrectly for 3 times in a row.

- If you improperly enter the PIN1 code 3 times in a row, the verification screen for unblocking PIN code will be displayed.

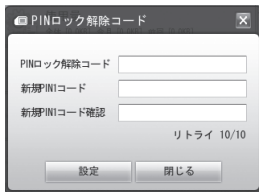

#### ■ Unlocking PIN code setting

- 1 Enter the unblocking PIN code to "PINロック解除コード (Unlocking PIN code)"
- 2 Enter the PIN1 code to change in "新規PIN1コード (New PIN1 code)"
- 3 In "新規PIN1コード確認 (Confirm new PIN1 code)", enter the PIN1 code that has been entered in "新規PIN1コード (New PIN1 code)" code again
- 4 Click "設定 (Set)"

#### Caution

- Be careful not to lose the UIM. DOCOMO is not responsible for the lost or stolen device.
- Do not transfer the UIM to others.
- Do not get the UIM scratched or transformed. The data stored in UIM will disappear or be changed.
- When connecting this terminal to a PC for the first time, you are required to enter PIN1 code to use UIM.
- If an incorrect PIN1 code is entered 3 times in a row, PIN code will be locked. In that case, enter unblocking PIN code.
- If an incorrect unblocking PIN code is entered 10 times in a row, UIM will be locked automatically. In that case, contact a docomo Shop.

## Resetting this terminal

Reset this terminal in the following cases.

- Operate abnormally.
- Insert a UIM when this terminal has already been inserted into your PC.

1 Click **リセット** in environment configuration screen



2 Click **はい**



This terminal starts resetting. After the reset finishes, it will return to the main screen.

## Checking The Newest Version of Software

When clicking  on the main screen (→P53), checking and setting about the update of S/W version is conductable.



**ON** : Every time when the connection software is launched, version of S/W will be checked whether it is the newest or not.

**OFF** : When **最新ソフトウェア確認** (Checking Software version)" is clicked, the connection software will check whether the newest version exists or not.

**最新ソフトウェア確認** : "最新ソフトウェア確認 (Checking the newest version of software)": Click in case of checking whether the newest version exists or not.

### Note

- Refer to "Software update manual" on DOCOMO's homepage which explains how to update to the newest version of software.
- Software update is not supported in Macintosh. Use Windows PC to update the software.





# Mobile Broadband

Mobile Broadband .....	64
Connecting through Mobile Broadband .....	65
Disconnecting Mobile Broadband .....	66
Changing APN Settings .....	66
Setting UIM .....	67

## Mobile Broadband

Use the mobile broadband installed in Windows 7 to communicate packet. Only Windows 7 supports mobile broadband.

In this manual, operations such as connecting/disconnecting mobile broadband, changing APN or setting PIN lock are described.

Visit Microsoft website for detailed information.

For connecting this terminal with Internet, agreement with the ISP (mopera U etc.) supporting service and data communication is required.

Visit DOCOMO website for detailed information (Japanese only).

※ For the following procedures, description will be based on the installation via only Communication Configuration File (Driver).

## Viewing Screen

### ■ APN screen



#### ① Current APN

- While connecting mobile broadband, the current APN will be displayed.

#### ② APN list

- If click APN, "接続 (Connect)" button/"切断 (Disconnect)" button will be displayed.

## ■ Property screen for setting each item

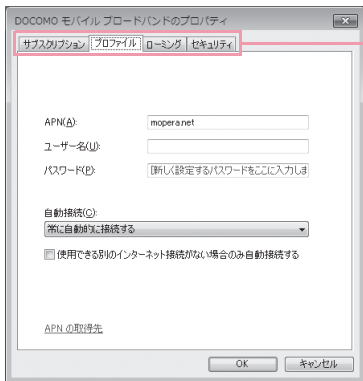

### 1 Setting tabs on Property screen

**Subscription:** Display provider details, own number, etc.

**Profile :** Set APN or auto connection. (→P66)

**Roaming\*\* :** Select a network to use while roaming.

**Security :** When connecting mobile broadband, set PIN authentication. (→P67)

※ Display only during international roaming.

## Connecting through Mobile Broadband

### 1 Connect this terminal with a PC

- Connecting method (→P24)

#### ■ When connecting for the first time

- 1 Click or displayed on the bottom right of the task tray
- 2 Right click "DOCOMO" and click "接続(Connect)"
- 3 Set each item ► Click "続行(Continue)"
  - Enter APN in "アクセス ポイント名(Access point name)" field.
  - Enter the settings specified by your provider or network administrator in "ユーザー名(User name)" and "パスワード(Password)".
  - If connect to "mopera U", connection is available with "ユーザー名(User name)" and "パスワード(Password)" blank.
- 4 Set auto connection ► Click "続行(Continue)"
  - Select from "常に自動的に接続する(Always connect automatically)", "ローミング時を除いて自動的に接続する(Connect automatically aside from roaming)" or "自動的に接続しない(Do not connect automatically)" in pull-down menu.

### 2 Follow the auto connection setting on profile tab to connect

#### ■ Always connect automatically

- Connect automatically after connecting with this terminal.

#### ■ Connect automatically aside from roaming

- Connect automatically while using in Japan. While roaming, operations are the same as "■ Do not connect automatically".



#### ■ Do not connect automatically

- 1 Click or displayed on the bottom right of the task tray
- 2 Select "DOCOMO" ► Click "接続(Connect)"



## Note

- A screen to confirm PIN1 code appears according to the setting. Enter PIN1 code after the screen appears.
- When mobile broadband is used to connect data communication, L-O2C connection software and dial up connection are not available to use.  
To "Disconnect" the mobile broadband or set auto connection setting to "自動的に接続しない(Do not connect automatically)" to enable to use L-O2C connection software or dial up connection.
- If select "常に自動的に接続する(Always connect automatically)", the amount of packet transmission may go huge due to the long time connection. Note that hefty fee may result.
- Note that communication fees may become high when "Always connect automatically" is set during overseas use.

## Disconnecting Mobile Broadband

- 1 Click  or  on the bottom right of task tray
- 2 Select "DOCOMO" ► Click "切断(Disconnect)"

## Changing APN Settings

- 1 Connect this terminal with a PC
  - Connecting method (→P24)
- 2 Click  or  on the bottom right of task tray
- 3 Right click "DOCOMO" and click "プロパティ(Properties)"
- 4 Click "プロパティ(Properties)" tab ► Set each item
  - Enter APN in "APN" field.
  - Enter the specified settings by provider or network administrator in "ユーザー名(User name)" "パスワード(Password)" field.
  - If connect to "mopera U", connection is available even if "ユーザー名(User name)" and "パスワード(Password)" are in blank.
  - In "自動接続(Auto connection)" field, select from "常に自動的に接続する(Always connect automatically)", "ローミング時を除いて自動的に接続する(Connect automatically aside from roaming)" and "自動的に接続しない(Do not connect automatically)".
  - If a PC accesses internet via LAN, check the check box of "使用できる別のインターネット接続がない場合のみ自動接続する(Connect automatically only when other available internet is not being connected.)" to not connect automatically on Windows.
- 5 Click "OK"

## Setting UIM

- "PINの有効化(PIN validation)", "PINの無効化(PIN invalidation)" and "PIN1コード変更(Change PIN1 code)" can be performed on UIM.

### 1 Connect this terminal with a PC

- Connecting method (→P24)

### 2 Click or on the bottom right of task tray

### 3 Right click "DOCOMO" and click "プロパティ (Properties)"

### 4 Click "セキュリティ (Security)" tab ► Set each item

- Set PIN1 lock in "PINの有効化(PIN validation)".
- Unlock PIN1 in "PINの無効化(PIN invalidation)".
- Change PIN1 in "PINの変更(Change PIN)".

### Note

- If connect mobile broadband under PIN validation, PIN1 code entry screen is displayed. In this case, this terminal cannot normally function with wrong PIN1 code.
- If an incorrect PIN1 code is entered 3 times in a row, PIN code will be locked. In that case, enter unblocking PIN code.
- If an incorrect unblocking PIN code is entered 10 times in a row, UIM will be locked automatically. In that case, contact a docomo Shop.
- If set to PIN invalidation, mobile broadband connection is available without confirming PIN1 code.



# Configuring Network Manually

Windows Version ..... 70

## Windows Version

Set the settings required when connecting dial up manually through L-02C APN setting tool.

- When L-02C connection software is being activated, L-02C APN setting tool cannot be activated.

## Setting APN

Set the access point (APN) in packet communication of dial up connection. Up to 10 APN can be set up and they are managed with cid's.

- The registration number (cid) 1 is pre-installed to mopera.net. Use cid2 to cid10 to set another APN.
- For APNs other than "mopera U", contact your ISP or network administrator.

### 1 Connect this terminal with a PC

- Connecting method (→P24)

### 2 Double click L-02C APN setting tool icon on the desktop

L-02C APN setting tool is launched.

### 3 Select "CID番号(CID number)" field to set Click "追加／編集(Add/Edit)"



#### ■ Deleting APN

- Select "CID番号(CID number)" field to delete
- Click "削除(Delete)"
- Click "はい(Yes)"
- Click "保存(Save)"
- Click "確認(Confirm)"

#### ■ Initializing APN

- Click "APN 初期化(Initialize APN)"
- Click "はい(Yes)"
- Click "保存(Save)"
- Click "確認(Confirm)"



#### 4 Enter the APN in "APN" field ▶ Click "設定 (Set)"



#### 5 Click "保存(Save)"

Confirmation screen appears.

#### 6 Click "確認(Confirm)"

The setting of APN finishes.

### Using Hyper Terminal on Windows XP

Describe how to set an APN by using "ハイパーターミナル (Hyper terminal)" attached on standard Windows XP.

- Windows 7 and Vista do not support "ハイパーターミナル(Hyper terminal)".

#### 1 Connect this terminal with a PC

- Connecting method. (→P24)

#### 2 Click "スタート(Start)" ▶ "すべてのプログラム (All programs)" ▶ "アクセサリ (Accessories)" ▶ "通信 (Communication)" ▶ "ハイパーターミナル (Hyper Terminal)"

Hyper Terminal starts.

#### 3 Enter a connection name in "名前 (Name)" field ▶ Click "OK"

#### 4 Enter a number does not exist (like "0") in "電話番号 (Phone Number)" field ▶ Check that "docomo LO2C" is displayed "接続方法 (Connection Method)" ▶ Click "OK"

- If more than one modem name is displayed in the "接続方法 (Connection Method)" field, check this terminal modem name and select a proper one. (→P40)

#### 5 Click "キャンセル(Cancel)" on connection screen

The Hyper Terminal screen opens.

## 6 Enter the APN in the following format

### ▶ Press

Enter AT+CGDCONT=<cid>,"<PDP type>","<APN>"

Enter the following information in the corresponding <cid>, <PDP type> and <APN> sections.

If "OK" appears after you enter the information, the APN has been setup.

**cid** : Enter any number from 2 to 10.  
※ Keep in mind that the old setting information will be overwritten if you select a cid number which has been set.

**PDP type** : Enter a connection method. Enter IP enclosed in quotation marks "".

**APN** : Enter an (APN) enclose it in quotation marks "".

- If the entered characters do not appear, enter ATE1.

### ■ To reset the specified cid APN settings

Enter AT+CGDCONT=<cid>

### ■ To view the registered APN

Enter AT+CGDCONT?

## 7 Confirm if "OK" is displayed

## 8 Click "ファイル(File)" ▶ "ハイパーターミナルの終了(Exit Hyper Terminal)"

## 9 Click "はい(Yes)" on confirming disconnection screen ▶ Click "いいえ(No)" on the confirming to save screen

Hyper Terminal quits, and the settings of the APN complete.

### Note

- The APN information is saved in this terminal. If you connect a different terminal, save the APN information again.
- If you want to use the APN information registered on the PC, register the same APN in the same cid of this terminal.
- When setting connection through PDP Type, enter the specified content by each provider or network administrator.

## Configuring Dial-up Network Manually

Set up the dial-up network on the PC.

- For setting up a connection to other than "mopera U", contact your ISP or network administrator.
- Because L-02C does not support dial-up network based on IPv6 protocol, the property of dial-up network needs to be modified in case of Windows OS which supports IPv6 protocol. (Reference: Windows 7→P76, Windows Vista→P80)

Example: Connecting to the DOCOMO Internet connection service "mopera U", which is registered to <cid>=1

### For Windows 7

- 1 Click "スタート(Start)" ▶ "コントロールパネル(Control panel)" ▶ "ネットワークとインターネット(Network and internet)" ▶ "ネットワークと共有センター(Network and sharing center)"
- 2 Click "新しい接続またはネットワークのセットアップ(Setup new connection or network)"

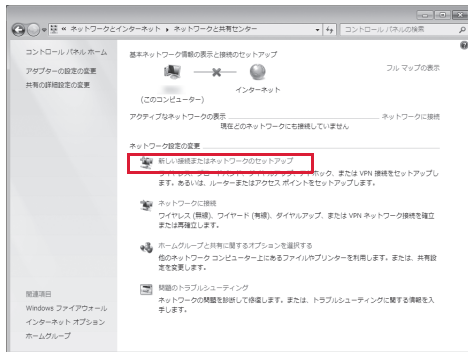

- 3 Select "ダイヤルアップ接続をセットアップします (Set up dial-up connection)" ▶ Click "次へ (Next)"

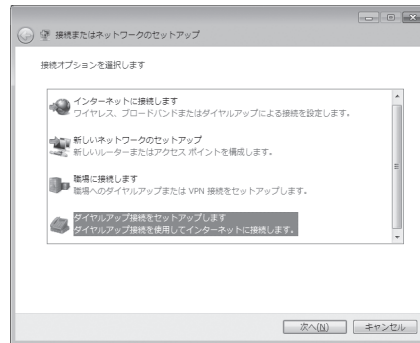

## 4 When the modem selection screen appears, click "docomo L02C"

The modem selection screen opens only when the PC has more than one modem.

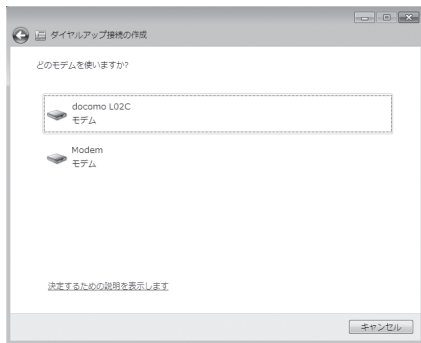

## 5 Configure each setting, then click "接続 (Connect)"

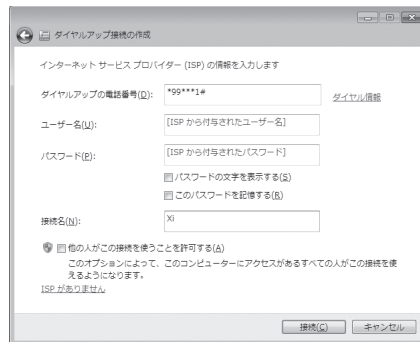

- Enter \*99\*\*\*<cid># in the "ダイヤルアップの電話番号(Phone number to a dial-up connection)". Enter the registration number of an APN set in <cid>. (→P70).
- Enter the user name and password specified by your ISP or network administrator in the "ユーザー名(User name)" and "パスワード>Password)" fields.
- You can leave the "ユーザー名(User name)" and "パスワード>Password)" fields unfilled when connecting to "mopera U".
- Enter a connection name in the "接続名 (APN)" field.

**6** Click "スキップ(Skip)" on the "(接続名)に接続中... (Connecting to (APN))" screen

The connection test will not be performed. Only the settings will be checked.



**7** Click "閉じる(Close)"

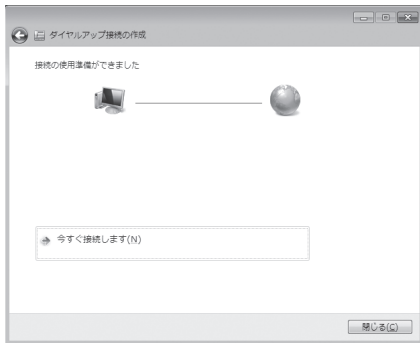

**8** Click "スタート(Start)" ► "コントロールパネル (Control panel)" ► "ネットワークとインターネット (Network and internet)" ► "ネットワークと共有センター (Network and sharing center)"

**9** "アダプターの設定の変更 (Change Adapter settings)" ► Select the created dial-up icon ► Right click the icon and select "プロパティ (Properties)"

**10** Check the settings on the "全般 (General)" tab window

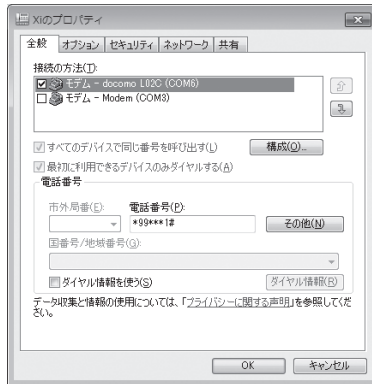

If two or more modems are connected to a PC, enable only "モデム - docomo L02C (Modem - docomo L02C)" in the "接続の方法 (Connection Method)" field.

- Disable "ダイヤル情報を使う (Use dialing information)".

## 11 Click "ネットワーク(Networking)" tab ► Configure each setting

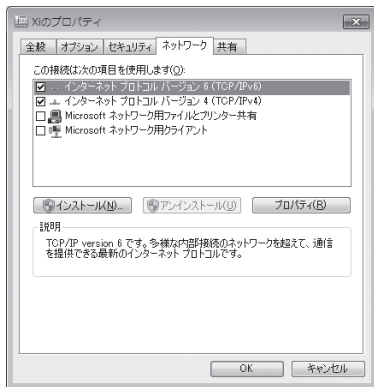

The settings for "QoS/パケットスケジューラ(QoS Packet Scheduler)" in "この接続は次の項目を使用します(This connection uses the following items)" field should follow your ISP or network administrator. Do not change the other items.

- Check if "インターネットプロトコルバージョン6(TCP/IPv6) (Internet Protocol version 6(TCP/IPv6))" is marked or not (if marked, unmark it).
- To set up TCP/IP, click "プロパティ (Properties)". Contact your ISP or network administrator for setting up.

## 12 Click the "オプション(Option)" tab ► Click "PPP設定(PPP Settings)"

## 13 Remove check marks from all items ► Click "OK"

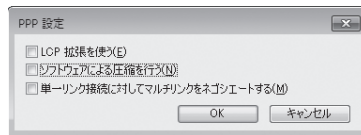

## 14 On the "オプション(Option)" tab window, click "OK"

- 1 Click  "スタート(Start)" ▶ "接続先 (Connection)"
- 2 Click "接続またはネットワークをセットアップします (Set up connection or network)"

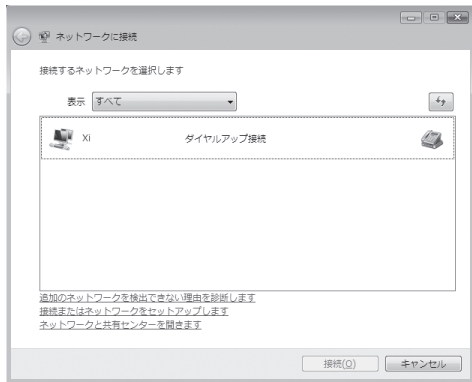

- 3 Select "ダイヤルアップ接続をセットアップします (Set up dial-up connection)" ▶ Click "次へ (Next)"

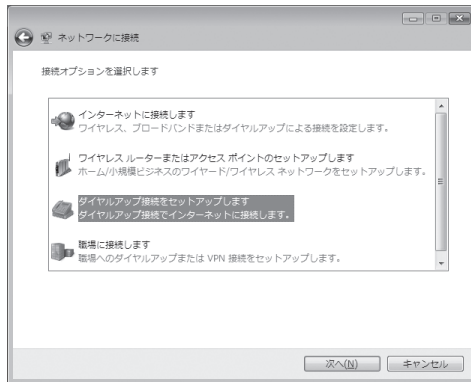

## 4 When the modem selection screen appears, click "docomo L02C"

The modem selection screen opens only when the PC has more than one modem.

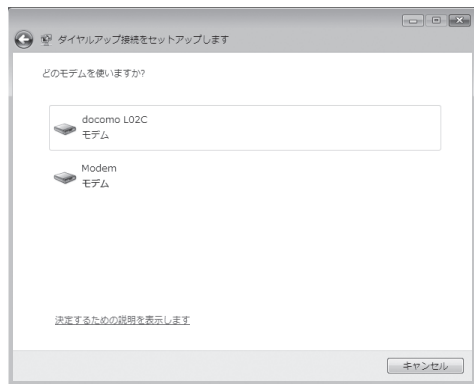

## 5 Configure each setting, then click "接続 (Connect)"

- Enter \*99\*\*\*<cid># in the "ダイヤルアップの電話番号(Phone number to a dial-up connection)". Enter the registration number of an APN set in <cid>. (→P70).
- Enter the user name and password specified by your ISP or network administrator in the "ユーザー名(User name)" and "パスワード(Password)" fields.
- You can leave the user name and password fields unfilled when connecting to "mopera U".
- Enter a connection name in the "接続名 (Connection Name)" field.

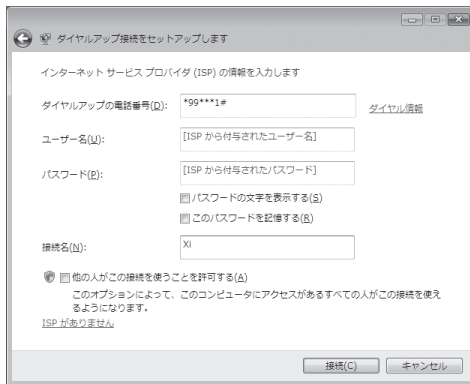



## 6 Click "スキップ(Skip)" on the "(接続名)に接続中... (Connecting to (APN))" screen

The connection test will not be performed. Only the settings will be checked.

- If you do not click "スキップ(Skip)", the connection to the Internet will be established.



## 7 Click "接続をセットアップします (Set up the connection)" ► "閉じる (Close)"



## 8 Click "スタート (Start)" ► "接続先 (Destination)"

## 9 Select the created dial-up connection icon ► Right click "プロパティ (Properties)"

## 10 Check the settings on the "全般(General)" tab window

If two or more modems are connected to a PC, enable only "モデム - docomo L02C (Modem - docomo L02C)" in the "接続の方法 (Connection Method)" field.

- Disable "ダイヤル情報を使う(Use dialing information)".

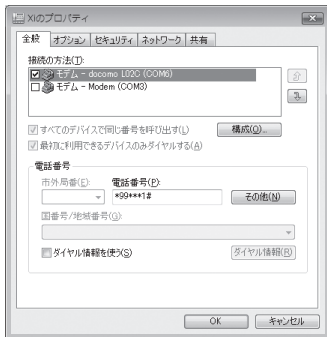

## 11 Click "ネットワーク(Networking)" tab ► Configure each item

The settings for "QoSパケットスケジューラ(QoS Packet Scheduler)" in "この接続は次の項目を使用します(This connection uses the following items)" field should follow your ISP or network administrator. Do not change the other items.

- Check if "インターネットプロトコルバージョン6(TCP/IPv6) (Internet Protocol version 6(TCP/IPv6))" is marked or not (if marked, unmark it).
- To set up TCP/IP, click "プロパティ (Properties)". Contact your ISP or network administrator for setting up.

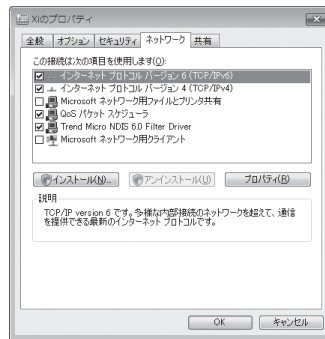

12 Click the "オプション(Option)" tab ▶ Click "PPP設定(PPP Settings)"

13 Remove check marks in all items ▶ Click "OK"

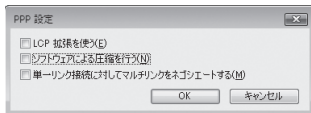

14 On the "オプション(Option)" tab window, click "OK"

## For Windows XP

1 Click "スタート(Start)" ▶ "すべてのプログラム (All programs)" ▶ "アクセサリ (Accessories)" ▶ "通信(Communication)" ▶ "新しい接続ウィザード(New Connection Wizard)"

2 On the New connection wizard screen, click "次へ(NEXT)"

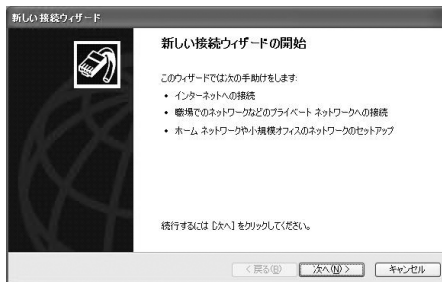

### 3 Select "インターネットに接続する (Connect to the Internet)" ▶ Click "次へ (Next)"

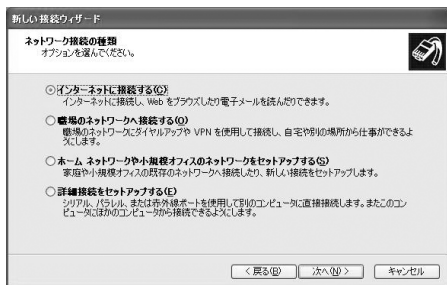

### 4 Select "接続を手動でセットアップする (Set up the connection manually)" ▶ Click "次へ (Next)"

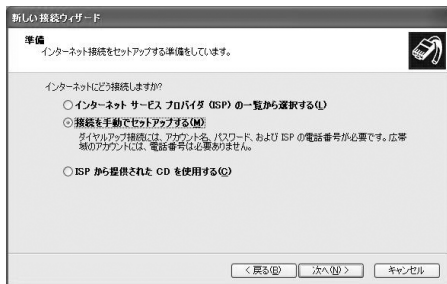

### 5 Select "ダイヤルアップモデムを使用して接続する (Use a dial-up modem to connect)" ▶ Click "次へ (Next)"

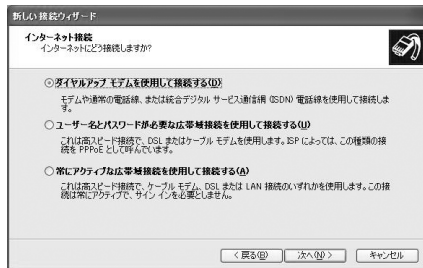

### 6 If "デバイスの選択 (Select a device)" screen appears, check in "モデム - docomo L02C (Modem - docomo L02C)" check box ▶ Click "次へ (Next)"

The "デバイスの選択 (Select a device)" screen appears only when the PC has more than one modem.

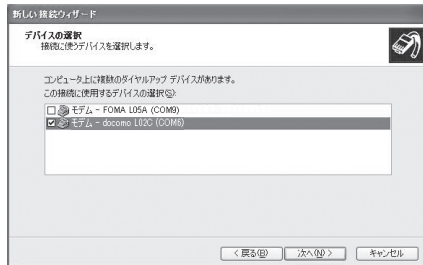

## 7 Enter a name in the "ISP名(ISP Name)" field ▶ Click "次へ(Next)"

## 8 Enter the APN number in the "電話番号(Phone Number)" field ▶ Click "次へ(Next)"

- Enter "\*99\*\*\*<cid>#", Enter the registered number of APN in <cid>. (→P70)

## 9 Select the connection usage range ▶ Click "次へ(Next)"

Select a user.

- Depending on the PC settings, this screen may not appear.

## 10 Fill in the "ユーザー名(User Name)", "パスワード(Password)", and "パスワードの確認入力(Confirm password)" fields ▶ Click "次へ(Next)"

Enter the information provided by your ISP or network administrator.

- Enter "ユーザー名(User name)" and "パスワード (Password)" correctly according to the instruction from the provider. Pay attention to the capital characters.
- For "mopera U", connection is available with "ユーザー名 (User name)" and "パスワード (Password)" blank.

## 11 Click "完了(Finish)"

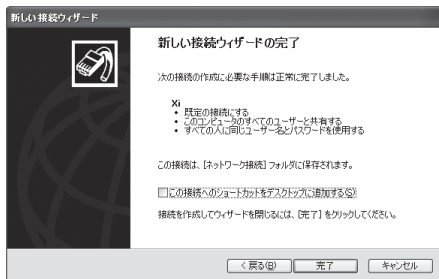

## 12 Click "スタート(Start)" ▶ "すべてのプログラム (All programs)" ▶ "アクセサリ(Accessories)" ▶ "通信(Communication)" ▶ "ネットワーク接続 (Network Connection)"

## 13 Select the created dial-up connection icon ▶ Right click ▶ Click "プロパティ(Properties)"

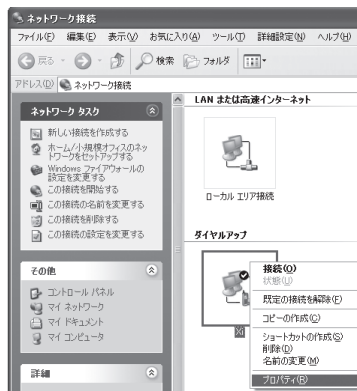

## 14 Check the settings on the "全般 (General)" tab window

- If more than one modem is connected to a PC, enable only "モデム - docomo L02C (COM6)" in the "接続の方法 (Connection Method)" field.
- Disable "ダイヤル情報を使う (Use dialing information)".

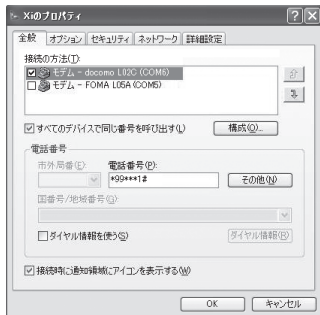

## 15 Click the "ネットワーク (Networking)" tab ► Confirm each item

- Select "PPP: Windows 95/98/NT4/2000, Internet" in the "呼び出すダイヤルアップ サーバーの種類 (Dial-up server type to call)" field
- Do not change the settings in "この接続は次の項目を使用します (This connection uses the following items)" field.
- When connecting to a provider, to confirm the TCP/IP settings contact the provider or network administrator.

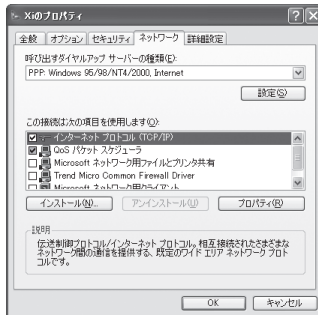

16 Click "設定(Settings)"

17 Remove check marks from all items ► Click "OK"



18 Click "OK" on the "ネットワーク(Networking)" tab window

## Communicating (Connecting by Dial-up)

This section describes steps to start and terminate communication without using L-02C connection software or Mobile Broadband.

- Check whether this terminal and the PC are connected properly before starting communication. (→P24)
- When performing communication, connect this terminal you used to configure the settings. If a different terminal is connected, L-02C connection software (including a drivers) may need to be reinstalled.
- When set PIN1 lock using L-02C connection software, start after unlocking PIN1.

1 Click  "スタート(Start)" ► "コントロールパネル(Control panel)" ► "ネットワークとインターネット(Network and internet)" ► "ネットワークと共有センター(Network and sharing center)" ► "アダプターの設定の変更(Change Adapter settings)" ► Double click the set APN icon

### ■ For Windows Vista

- Click  "スタート(Start)" ► "接続先(APN)" ► Select the set APN ► Click "接続(Connect)".

### ■ For Windows XP

- Click "スタート(Start)" ► "すべてのプログラム(All programs)" ► "アクセサリ(Accessories)" ► "通信(Communication)" ► "ネットワーク接続(Network connection)" ► Double click the set APN icon.



## 2 Enter "ユーザー名(User Name)" and "パスワード (Password)" ▶ Click "ダイヤル(Dial)"

The APN will be connected.

- To connect to "mopera U", you can leave the "ユーザー名 (User Name)" and "パスワード (Password)" fields unfilled and click "ダイヤル(Dial)". If another ISP or dialup connection is selected, fill in the "ユーザー名 (User Name)" and "パスワード (Password)" fields and click "ダイヤル (Dial)".
- You can save the user name and password or just the password to skip entering them next time.
- Depending on the operating system, a connection completion screen may appear when the dial-up connection is established. However, the connection completion screen does not appear if you previously set the completion message not to appear.



## Disconnecting Communication

Exiting the Internet browser may not terminate the connection. Perform the following steps to terminate the connection securely.

### 1 Click the dial-up icon on the task tray of a PC

A screen indicating the connection status appears.

### 2 Select an APN ▶ Click "切断(Disconnect)"

Communication is disconnected.



#### ■ For Windows Vista

- Click "接続または切断(Connect or disconnect)" ▶ "切断 (Disconnect)".

#### ■ For Windows XP

- Click "切断(Disconnect)".

#### Note

- The communication speed shown on the PC screen may be different from the actual communication speed.



# Overseas Use

International Roaming Service (WORLD WING) ..	90
Services Available Overseas .....	90
Before Using Overseas .....	91
Setting the Searching Method for Available Networks .....	92
Configuring Network .....	92

## International Roaming Service (WORLD WING)

International roaming service enables you to use this terminal domestically in a service area of international carrier associated with DOCOMO.

### ■ Available area

This terminal can be used in 3G network and GPRS network service areas. Also, it can be used in the countries and areas that support 3G850MHz. Check available areas.

- Before using this terminal overseas, see the following items.
  - "Mobile Phone User's Guide [International Services]"
  - DOCOMO International Services website
- For areas out of Xi area such as overseas, connect to 3G or GPRS network.

## Services Available Overseas

Service	Description
Data Communication	Available for data communication using packets communication.

### Note

- For details on available communication services while using international roaming, refer to Mobile Phone User's Guide [International Services] or visit DOCOMO "International Service Website".
- L-O2C does not support voice call or video telephony features.

## Before Using Overseas

STEP1 : Before Leaving Japan

STEP2 : While Overseas

STEP3 : After Coming Back to Japan

### Before Leaving Japan

#### ■ Subscription

- "WORLD WING" is always applied together with your subscription. Contact My docomo, docomo Shop or docomo Information Center for details.
- A UIM made available for WORLD WING must be inserted in this terminal.

#### ■ Power source and voltage in the country or region of stay

- Countries and regions may have different power sources, voltages or power outlet shapes. Check these in the INSTRUCTION MANUAL for your PC or websites of the PC manufacturer in advance.

#### ■ Network setup

- You can change network setup from overseas. (→P92)

#### ■ Usage charge

- The charge for usage (bill for packet communication) abroad is different from the charge in Japan.

#### ■ Internet access

- For overseas access points or settings for using the Internet overseas, contact your ISP.
- If you subscribe to mopera U, visit the mopera U website. <http://www.mopera.net/> (Japanese only)

### While Overseas

#### ■ Switching networks

Searching for and connecting to an access point are performed automatically by default. No special settings are required.

#### ■ Main screen display area

The name of the connected carrier is displayed if "オペレータ名表示設定(Operator name display)" is set to "表示する(Display)". (→P92)  
Also the information of the internet being connected is displayed. (→P53)

#### Note

- You can manually switch networks if you want to connect to a particular network. See procedure 3 of "Configuring Network". →P93

### Inquiries overseas

If your UIM is lost or stolen overseas, contact DOCOMO immediately and temporarily suspend your subscription. For inquiry information, see "docomo Information Center" on the back of this manual. Call or data communication charge will still on you after the terminal was lost or stolen.

## After Coming Back to Japan

After coming back to Japan, you can use within Xi area or FOMA area.

### ■ If connection can not be established

Set to "自動検索(Auto search)" from "ネットワーク検索方法 (Search network)" of "Configuring Network". (→P92)

## Setting the Searching Method for Available Networks

## Switching Carriers Manually

This terminal is set to automatically find and switch to an available network in the country of stay by default. However, if you have a preferred network in the area or network cannot be found automatically, you can set to a network manually. For details, see procedure 3 of "Configuring Network". (→P93)

## Configuring Network

- Allow you to configure network by L-O2C connection software.
- Available to set only during international roaming.

- 1 Click "ネットワーク設定(Network configuration)" in environment configuration screen (→P56)

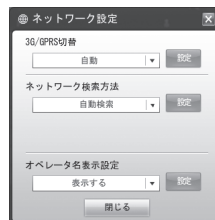

- 2 Specify a prior network in "3G/GPRS切替 (Switch 3G/GPRS)"

### 3 Specify a search method from "ネットワーク検索方法(Search network method)"

#### ■ 自動検索(Auto search)

Network can be searched automatically.

#### ■ 手動検索(Search manually)\*

- Connect to the listed networks manually.
- How to manually configure network
  - Select "手動検索(Search manually)"
  - Click "はい(Yes)".
  - The available network list will be displayed after searching.
  - Select one from the available networks.
  - Click .
  - Click "はい(Yes)".

※ If network search mode is set to "manual" overseas, reset to "自動検索(Auto search)" after coming back to Japan.

### 4 Specify if display or hide the network information in "オペレータ名表示設定(Operator name display)"

#### ■ 表示する(Display)

- The name of the network receiving current service is displayed on the screen.

#### ■ 表示しない(Hide)

- The name of the network receiving current service is not displayed on the screen.

### 5 Click the applicable

- The information entered will not be set without clicking the applicable .

### 6 Click "はい(Yes)"

### 7 Click "閉じる(Close)"

#### Note

- Even if "オペレータ名表示設定(Operator name display)" is set to "表示する(Display)", the carrier's name is not displayed while being within domestic (Xi area/FOMA area).
- Connecting to Internet may not be able to operate properly when network settings are changed manually.
- While using overseas
  - When set "ネットワーク検索方法(Search network)" to "自動検索(Auto search)", it will search the available carrier automatically and connect again if move to an area out of service.
  - Some communication services may not be available depending on the overseas carrier or network.
  - When using overseas, internet cannot be accessed by IPv6. Use IPv4 to set "接続方式(Connection type)" of "プロファイル設定(Profile settings)" to "IPv4IPv6" to access internet. If set to "IPv6", internet is not available to access.





# Appendix/Troubleshooting

AT Commands .....	96
AT Command List .....	97
Troubleshooting .....	113
Error Messages .....	116
Warranty and After-Sales Service .....	117
Updating Software .....	118
Main Specifications .....	119
Export Administration Regulations .....	120
Intellectual Property Rights .....	122
Index .....	124

## AT Commands

AT commands are used to check this terminal function settings or status by using a PC. Usually, the communication software issues AT commands so you do not need to be concerned about them. Use AT commands if you want to control this terminal in your own way.

### Form of AT Commands

AT commands should be entered on the Terminal Mode screen of the communication software. Use only single-byte alphanumeric characters.

<Example>

ATD \* 99 \* \* \* 1# 

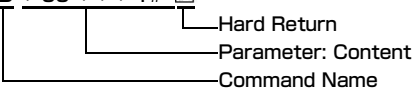

Hard Return  
Parameter: Content  
Command Name

- An AT command must be entered on a single line including parameters (numbers and symbols) following the command. On the Terminal Mode screen of the communication software, "one line" is from the first character to the character before .

#### Note

- In the Terminal mode, a PC functions as a communication terminal. Characters entered from the keyboard are sent to a line connected to a communication port.

## AT Command List

The following AT commands can be used on the "L-02C" modem port.

- [&F] : A command to initialize settings used as AT&F command.
- [?][=?] : The current settings appear when adding "?" at the end of the command, and the effective range of the current settings appears when adding "=?" at the end of the command.

Command	Overview	Parameters/Description	Examples of Commands
AT	OK is displayed.	-	AT OK
AT&C<n> [&F]	Select the operating conditions of the circuit CD signal for TE.	n=0: Always keeps CD signal ON n=1 (default): CD changes depending on the other party's modem status.	AT&C1 OK
AT&D<n> [&F]	Select the operation when receiving circuit ER signal from TE.	n=0 : Same as n=2 n=1 : Same as n=2 n=2 (default) : If ER signal is changed from ON to OFF, line will be disconnected and become offline command.	AT&D1 OK
AT&F<n>	Reset the settings on this terminal with the nonvolatile memory contents. If performed during a communication, the line is disconnected.	Only n=0 can be set (Skippable)	AT&F OK
AT+CEER	Set up error report is displayed.	-	AT+CEER +CEER: 36  OK

Command	Overview	Parameters/Description	Examples of Commands
AT+CEREG=<n> [&F] [?] [=?]	Set if notify EPS network registration.	<p>&lt;n&gt; : Set if send unsolicited result code  n=0 : Do not send unsolicited result code (default)  n=1 : Send network registration status as unsolicited result code  n=2 : Send network registration status and location information as unsolicited result code</p> <p>&lt;stat&gt; : Packet data exchange network registration status  stat=0 : Outside area and not searching  stat=1 : Within area (HOME)  stat=2 : Outside area and Attach or searching  stat=3 : Registration is refused  stat=4 : Unclear (other)  stat=5 : Within area (while roaming)</p> <p>&lt;lac&gt; : Location area code  This parameter is string parameter. It will be surrounded by "". Notation as a hex of 2byte.</p> <p>&lt;ci&gt; : Cell ID  This parameter is string parameter. It will be surrounded by "". Notation as a hex of 4byte.</p> <p>&lt;AcT&gt; : Within area  AcT=0 : GSM  AcT=2 : 3G (FOMA)  AcT=7 : LTE (Xi)</p> <p>&lt;rac&gt; : Routing area code  This parameter is string parameter. it will be surrounded by "". Notation as a hex of 1byte.</p>	AT+CEREG? +CEREG: 2,1,"00C3","01","00 00C4D1",7  OK
AT+CGDCONT [?] [=?]	Set APN when sending Packet communication.	Refer to P111	Refer to P111

Command	Overview	Parameters/Description	Examples of Commands
AT+CGEQMIN [?] [=?]	Register criteria value for determining if QoS (Quality of Service) sent from network when PPP Packet communication is established is acceptable or not.	Refer to P111	Refer to P111
AT+CGEQREQ [?] [=?]	Set QoS(Quality of Service) to request for the network when PPP Packet communication starts.	Refer to P111	Refer to P111
AT+CGMR	Display IMEISV value of this terminal.	-	AT+CGMR 1234512345123 456  OK

Command	Overview	Parameters/Description	Examples of Commands
AT+CGREG=<n> [&F] [?] [=?]	Set if notify GPRS network registration.	<p>&lt;n&gt;: Set if send unsolicited result code            n=0 : Do not send unsolicited result code (default)            n=1 : Send network registration status as unsolicited result code            n=2 : Send network registration status and location information as unsolicited result code</p> <p>&lt;stat&gt; : Packet data exchange network registration status            stat=0 : Outside area and not searching            stat=1 : Within area (HOME)            stat=2 : Outside area and Attach or searching            stat=3 : Registration is refused            stat=4 : Unclear (Other)            stat=5 : Within area (while roaming)</p> <p>&lt;lac&gt; : Location area code            This parameter is string parameter. It will be surrounded by ". Notation as a hex of 2byte.</p> <p>&lt;ci&gt; : Cell ID            This parameter is string parameter. It will be surrounded by ". Notation as a hex of 4byte.</p> <p>&lt;AcT&gt; : Within area            AcT=0 : GSM            AcT=2 : 3G (FOMA)            AcT=7 : LTE (Xi)</p> <p>&lt;rac&gt; : Routing area code            This parameter is string parameter. It will be surrounded by ". Notation as a hex of 1byte.</p>	AT+CGREG? +CGREG: 2,1,"00C3",0000C 4D1",6,"01"  OK
AT+CGSN	Display the serial number of this terminal.	-	AT+CGSN 12345678901 2345  OK

Command	Overview	Parameters/Description	Examples of Commands
AT+CIND [?] [=?]	The signal status of this terminal is displayed. Execute "AT+CIND=?", then appears as "+CIND:<battchg>,<signal>,<service>".	<battchg> battchg=0~5 : Battery charge level * Not supportive.  <signal> signal=1 : 0 or 1 bar of antenna is displayed signal=3 : 2 bars of antenna are displayed signal=5 : 3 bars of antenna are displayed  <service> service=0 : Within area service=1 : Out of area	AT+CIND? +CIND:5,5,1  OK  AT+CIND=? +CIND:("battchg",(0-5)),("signal",(0-5)),("service",(0,1))  OK
AT+CLCK=<fac>,<mode>[,<passwd>] [=?]	Change PIN lock setting and inquire the setting items.	<fac>: Lock type fac="SC" : Operation of setting UIM PIN lock  <mode>: Lock control mode=0 : Unlock PIN lock mode=1 : Set PIN lock mode=2 : Status of PIN lock  <passwd>: PIN code Execute "AT+CLCK="SC".2", then appears as "+CLCK:<state>".  <state>: Lock status 0 : PIN is unlocked 1 : PIN is locked	AT+CLCK="SC".0;"000"  OK  AT+CLCK="SC".2 +CLCK:1  OK

Command	Overview	Parameters/Description	Examples of Commands
AT+CMEE=<n> [&F] [?] [=?]	Set the error report form of this terminal.	n=0: Display "ERROR". (default) n=1: Display in the form of "+CMEE ERROR: xxxx" (where xxxx are numbers) n=2: Display in the form of "+CMEE ERROR: xxxx" (where xxxx are text) ※ If using ATZ or AT&F command to default, "0" is setup. Note that when connecting L-02C to power, the value of ATZ or AT&F command differs.	AT+CMEE=0 OK  AT+CMEE? +CMEE:0  OK
AT+ CNUM	Display the own number of this terminal.	Executing "AT+CNUM" displays in the form of "+CNUM: <number>, <type>".  number: phone number type=129: Excluding the international access code+ type=145: Including the international access code+	AT+CNUM +CNUM: "09012345678",1 29  OK



Command	Overview	Parameters/Description	Examples of Commands
<pre>AT+COPS= [&lt;mode&gt; [,&lt;format&gt; [,&lt;oper&gt; [,&lt;AcT&gt; ]]]] [?] [=?]</pre>	<p>Select NW operator and set.</p>	<p>&lt;mode&gt; Parameter is supporting 0-4.</p> <p>&lt;format&gt; Parameter is only supporting 2(default).</p> <p>&lt;oper&gt; Parameter displays MCC3 digits, MNC2 digits. For example, if PLMN Number is 440 (MCC) 10 (MNC), &lt;oper&gt;="44010".</p> <p>&lt;stat&gt; Parameter is supporting the followings. stat=0 : unknown stat=1 : available stat=2 : current stat=3 : forbidden</p> <p>&lt;AcT&gt;: Within area AcT=0 : GSM AcT=2 : 3G (FOMA) AcT=7 : LTE (Xi)</p>	<pre>AT+COPS=0 OK  AT+COPS? +COPS: 0,2,"44010",7 OK  AT+COPS=1,2,"44 010",7 OK</pre>

Command	Overview	Parameters/Description	Examples of Commands
AT+CPAS [=?]	Display this terminal state.	Displays in the form of "+CPAS : <n>".  n=0: Available n=1: Unavailable n=2: Unclear n=3: Available and while incoming call receiving n=4: Available and communicating	AT+CPAS +CPAS:0  OK
AT+CPIN="PIN"/ AT+CPIN="PUK" , "PIN" [?]	Command to enter the PIN1 code or unblocking PIN code for UIM.	Enter the PIN1 code for "PIN", and enter unblocking PIN code for "PUK".  Executing "AT+CPIN?" displays "+CPIN: <n>". n=READY: Authenticated n=SIM PIN: Waiting for entry n=SIM PUK: Waiting for unblocking PIN code entry n=ERROR: Locked	(+CPIN:SIM PIN status) AT+CPIN="1234" OK  (+CPIN:SIM PUK status) AT+CPIN="12345678", "1234" OK
AT+CPWD=<fac>,<oldpwd>,<newpwd> [=?]	Change password of PIN code.	<fac> fac="SC" : Change PIN1 code of UIM  <oldpwd><newpwd>means enter the current PIN code and new PIN code. Execute "AT+CPWD=?", then appears as"+CPWD:("SC",<pwdlength>". <pwdlength> displays maximum character number of PIN.	AT+CPWD="SC",00 00,1111 OK

Command	Overview	Parameters/Description	Examples of Commands
AT+CR=<mode> [&F] [?] [=?]	Set if display service report.	<mode> 0 : Do not return report (default). 1 : Return report.	AT+CR=0 OK  AT+CR? +CR:0  OK
AT+CREG [&F] [?] [=?]	Set if notify EPS network registration and make an inquiry.	<n>: Set if send unsolicited result code n=0 : Do not send unsolicited result code (default) n=1 : Send network registration status as unsolicited result code n=2 : Send network registration status and location information as unsolicited result code  <stat> : Packet exchange network registration status n=0 : Outside area and not searching	AT+CREG=0 OK  AT+CREG? +CREG:0,0  OK
AT+CSQ [=?]	Display the wireless quality of this terminal.	Execute "AT+CSQ", then appears as "+CSQ:<rssi>,<ber>".  <rssi> rssi=0 : Under -113dBm rssi=1 : -111dBm rssi=2~30 : -109dBm~-53dBm rssi=31 : Over -51dBm rssi=99 : Unclear or not detected  <ber> ber=0~7 : RXQUAL ber=99 : Unclear or not detected	AT+CSQ +CSQ:31,7  OK

Command	Overview	Parameters/Description	Examples of Commands
AT+GCAP	Display the capability list of this terminal.	-	AT+GCAP +GCAP: +CGSM,+W  OK
AT+GMI	Display the manufacturer of this terminal.	-	AT+GMI LG Electronics Inc  OK
AT+GMM	Display the name of this terminal.	-	AT+GMM docomo L02C  OK
AT+GMR	Display the S/W version of this terminal.	-	AT+GMR L02C-MDM9200- VXXX-XXX-XX- XXXX-DCM-JP  OK
AT+IFC=<n>,<m> [&F] [?] [=?]	Set the local flow control method between the PC and this terminal.	n : DCE by DTE control n=0 : No flow control. n=1 : Perform XON/XOFF flow control. n=2 (default): Perform RS/CS (RTS/CTS) flow control.  m : DTE by DCE control m=0: No flow control m=1: Perform XON/XOFF flow control. m=2(default) : Perform RS/CS (RTS/CTS) flow control	AT+IFC=2,2 OK  AT+IFC=1,1 OK  AT+IFC=0,0 OK

Command	Overview	Parameters/Description	Examples of Commands
AT+WS46=<n> [?] [=?]	Set the wireless network to be used by this terminal when dialing.	n=12 : 3GPP Systems *For AT+WS46? , the answer is only 25.	AT+WS46=12 OK  AT+WS46? 25  OK
A/	Retry a command just before performing.	 is not needed after entering command.	A/ OK
ATA	Display NO CARRIER under offline command mode.	-	ATA NO CARRIER
ATD	Send packet.	Sending packet : ATD*99***<cid>#<cid>1~10 : + Display the APN that configured +CGDCONT	ATD*99# CONNECT
ATE<n> [&F]	Set whether to echo back the text sent from a PC.	n=0 : Not echo back. n=1 (default) : Echo back.	ATE0 OK  ATE1 OK
ATH<n>	The line is disconnected.	Only n=0 (default) can be specified.	ATH OK

Command	Overview	Parameters/Description	Examples of Commands
ATI<n>	Display the recognition code.	n=0 : Display [NTT DOCOMO, INC.] n=1 : Display the name of this terminal (Same as +GMM). n=2 : Display this terminal version (same as +GMR). n=3 : Display OK. n=4 : Display the details of communication functions of this terminal.	AT1 NTT DOCOMO, INC.  OK  AT10 NTT DOCOMO, INC.  OK  AT11 docomo L02C  OK  AT12 L02C-MDM9200- VXXX-XXX-XX- XXXX-DCM-JP  OK  AT13 OK  AT14 4  OK
ATS0=<n> [&F] [?]	Set the RING value while receiving automatically.	n=0 (default) : Cannot receive automatically. n=1 ~255 : Receive automatically by specified RING value.	ATS0=0 OK  ATS0? 000  OK

Command	Overview	Parameters/Description	Examples of Commands
ATS3=<n> [&F] [?]	Set the return character (CR) to recognize the end of AT command text string.	Only n=13 (default) can be specified.	ATS3=13 OK
ATS4=<n> [&F] [?]	Set the line feed (LF) character. It is positioned next to the return character (CR) if displaying the result code in English characters.	Only n=10 (default) can be specified.	ATS4=10 OK
ATS5=<n> [&F] [?]	Set the back space (BS) character to delete the last character in the input buffer while AT commands are entered.	Only n=8 (default) can be specified.	ATS5=8 OK
ATS6=<n> [&F] [?]	Set pause duration till dial.	n=2~10 : Pause for n seconds (default : n=5).	ATS6=5 OK
ATS8=<n> [&F] [?]	Set pause duration of comma dial.	n=0 : No pause. n=1~255 : Pause for n seconds (default : n=2).	ATS8=3 OK  ATS8? 003  OK
ATS10=<n> [&F] [?]	Set delay duration of auto disconnection.	n=1~255 : Disconnect automatically after n/10 second (default : n=1).	ATS10=1 OK  ATS10? 001  OK
ATQ<n> [&F]	Set if display result code.	n=0 (default) : Display result code. n=1 : Not display result code.	ATQ0 OK
ATV<n> [&F]	Set the display method of the result code.	n=0 : Display in numeric characters. n=1 (default): Display in text.	ATV1 OK

Command	Overview	Parameters/Description	Examples of Commands
ATX<n> [&F]	Set if detect dial tone.	n=0 : No busy tone detected, no dial tone detected, no speed display n=1 : No busy tone detected, no dial tone detected, speed display detected n=2 : No busy tone detected, dial tone detected, speed display detected n=3 : Busy tone detected, no dial tone detected, speed display detected n=4 (default) : Busy tone detected, dial tone detected, speed display detected	ATX1 OK
ATZ	Reset the settings on this terminal with the nonvolatile memory contents. If performed during a communication, the line is disconnected.	-	ATZ OK



## Supplementary Explanation of AT Commands

### ■ Command name : +CGDCONT

- Overview  
Set APN when sending packet connection.
- Form  
+CGDCONT=[<cid>[,<"PDP type">["<APN>"]]]
- Parameter descriptions  
Set the destination (APN) when sending packets. See the following examples for command operations.  
<cid>\*<sup>1</sup> : 1 to 10  
<PDP type>\*<sup>2</sup> : IP  
<APN>\*<sup>3</sup> : Optional
  - ※1 <cid> is the number used to control the destination (APN) for the packet communication to be registered in this terminal. 1 to 10 can be registered. The default value of <cid>=1 is "mopera.net". Set cid number from 2 to 10.
  - ※2 <PDP type> is a protocol for packet communication. The pre-installed <PDP type>=IP is set to <cid>=1 as default.
  - ※3 <APN> is optional string that indicates each destination.
- Command examples  
Command to register an APN with the name of abc (When PDP type is IP, cid is 2)  
AT+CGDCONT=2,"IP","abc"  
OK
- Operations without a parameter  
AT+CGDCONT= : Clear all the settings of <cid>. However, the setting of <cid>=1 is reset to the value when purchasing.  
AT+CGDCONT? : Display the current settings.

### ■ Command name: +CGEQMIN=[Parameter]

- Overview  
Register the threshold to accept the QoS (Quality of Service) sent from the network when packet communication is established.  
LTE data communication is not supported.
- Format  
+CGEQMIN=<cid>[,<Maximum bitrate UL>[,<Maximum bitrate DL>]]]
- Parameter description  
<cid>\*<sup>1</sup> : 1 to 10  
<Maximum bitrate UL>\*<sup>2</sup> : None (default)  
<Maximum bitrate DL>\*<sup>2</sup> : None (default)
  - ※1 <cid> is a number used to manage the access point (APN) for the packet communication registered in this terminal.
  - ※2 <Maximum bitrate UL> and <Maximum bitrate DL> indicate the minimum communication speed [kbps] of upload and download traffic respectively between this terminal and the base station. If these are set to None (default), all speeds are permissible. Be aware that a packet communication may not be established because any other speed than this is not permissible.
- Command examples
  - (1) Command to permit all speeds for both upload and download (When cid=2)  
AT+CGEQMIN=2  
OK
  - (2) Command to permit only 5,760kbps for upload and 7,232kbps for download (When cid=2)  
AT+CGEQMIN=2,,5760,7232  
OK
  - (3) Command to permit 5,760kbps for upload and all speeds for download (When cid=2)  
AT+CGEQMIN=2,,5760  
OK

(4) Command to permit all speeds for upload and only 7,232kbps for download (When cid=4)  
AT+CGEQMIN=4,...,7232  
OK

#### ■ Command name: +CGEQREQ=[Parameter]

- Overview  
Set the QoS (Quality of Service) requested to the network when packet communication is dialed.
- Format  
+CGEQREQ=[<cid>[,<Maximum bitrate UL>[,<Maximum bitrate DL>]]]
- Parameter description  
<cid>\*1 : 1 to 10  
<Maximum bitrate UL>\*2 : None (default)  
<Maximum bitrate DL>\*2 : None (default)  
\*1 <cid> is a number used to manage the access point (APN) for the packet communication registered in this terminal.  
\*2 <Maximum bitrate UL> and <Maximum bitrate DL> indicate the minimum communication speed [kbps] of upload and download traffic respectively between this terminal and the base station. If these are set to None (default), Qos of network is not required.
- Command example  
Command to require 5,760kbps for upload and 7,232kbps for download (When cid=2)  
AT+CGEQREQ=2,2,5760,7232  
OK

#### **Note**

- This command, (+CGDCONT, +CGEQMIN, +CGEQREQ) is not reset by [F] and [Z], either.

## Result Codes

#### ■ List of result codes







Numeric display	Text display	Description
0	OK	Operation performed properly
1	CONNECT	Connected to other party
3	NO CARRIER	Line disconnected
4	ERROR	Unable to accept command
100	RESTRICTION	NW restriction display

## Troubleshooting

First, check whether software is required to update. Update software if necessary. (Updating Software⇒P118) Contact General Inquiries specified by DOCOMO located in "Repairs" (Japanese only) at the last page of the manual if the symptom is not improved after confirming the item to check.

### ■ This terminal is not recognized

Symptom	Check
This terminal is not recognized	Insert the USB port firmly into this terminal.
	Verify the L-02C Communication Configuration Files (Drivers) for this terminal functioning properly.→P33, P43
	This terminal may not be recognized correctly when activating the PC with this terminal being connected, during restarting or after retrieving from the states of standby (sleeping)/stopping during packet communication. Remove this terminal from the PC and insert again after restarting the PC. Delete the driver of this terminal on device manager when "!" appears in this terminal device. Only install the driver again.
	The UIM will not be able to use if PIN1 unlock code is wrongly entered 10 times in a row. For further information, visit docomo Shop.

Symptom	Check
This terminal is not recognized	<p>■Notes when CD/DVD playback and written software are being installed into a PC</p> <p>In some PCs, this terminal may not be recognized normally depending on the playback of the installed CD/DVD and the version of the written application software even if this terminal is connected when the application software residents* or during being activated. Try the following methods in that case.</p> <p>■ To recognize after finishing the application being activated</p> <ol style="list-style-type: none"><li>1 Remove this terminal from the PC</li><li>2 Finish CD/DVD playback and the executants of written application software</li><li>3 Connection this terminal to the PC</li></ol> <p>■ To recognize via  (DOCOMO) icon</p> <ul style="list-style-type: none"><li>● For Windows 7<ul style="list-style-type: none"><li>• Double click  "スタート(Start)"<ul style="list-style-type: none"><li>▶  "DOCOMO" icon of "コンピューター (Computer)".</li></ul></li></ul></li><li>● For Windows Vista<ul style="list-style-type: none"><li>• Double click  "スタート(Start)"<ul style="list-style-type: none"><li>▶  "DOCOMO" icon of "コンピューター (Computer)".</li></ul></li></ul></li><li>● For Windows XP<ul style="list-style-type: none"><li>• Double click "スタート(Start)"<ul style="list-style-type: none"><li>▶  "DOCOMO" icon of "マイコンピュータ (My computer)".</li></ul></li></ul></li></ul> <p>※The software under the state of icons being displayed on task tray is also included.</p>

## ■ Communication problems

Symptom	Check
Communications are not possible	Verify if signals are received in the service area.
	Check if you set the UIM setting to "Unlocking PIN1". →P58 If it is set to "PIN1 Lock", launch the L-02C connection software, then enter PIN1 code. →P59
	Check the setting of this terminal and the APN registration.
	When connecting manually by L-02C is not available, open the property of dial-up connection and make sure that only "docomo LO2C" has check mark in "接続の方法(Connection method)". (If the modem inside PC or other modems have check marks, packet connection may be incorrect.)
	Even if internet auto connection is set to "On", auto connection may not be available depending on the PC or NW. In that case, remove this terminal and insert it into the PC again.
When using internet by this terminal, make sure that wired/wireless LAN or other communication devices are disconnected.	

## ■ Problems with AT Commands

Symptom	Check
[ERROR] appears when AT command is entered	Verify if you entered a correct AT command.
	Check the properties of the terminal software to see whether a device other than this terminal is selected.
[OK] does not appear after an AT command is entered	Check the L-02C Communication Configuration Files (Drivers) have been installed and functioned properly.
	Verify if the commands start with "AT" or "at".

## ■ Zero installation fails

Symptom	Check
New hardware detection screen appears	If "L-02Cセットアップ (L-02C Setup)" screen does not appear, and the input of driver is required, cancel it temporarily. Remove this terminal from the USB port of PC and insert again.
	※ PC configuration may cause installation failed. In this case, install from CD-ROM →P38.
	Do not start zero installation during OS activation. It may take several minutes depending on the PC. Make sure to start the installation after the PC runs normally.

## ■ Other problems

Symptom	Check
The terminal stopped working suddenly	Verify that the UIM is properly inserted to this terminal.→P19
	Your PC operating environments may have changed because a new peripheral or software was installed. Make a confirmation with manufacturer or maker of accessory or software.
This terminal is not detected if it is inserted into a USB port of PC after installing the L-02C Communication Configuration Files (Drivers)	Please confirm the following. <ul style="list-style-type: none"><li>• Whether the PC or OS you are using is in the latest condition? (If required, apply revision program of OS or a maker.)</li><li>• Whether this terminal recognizes normally when other USB devices are inserted into the USB port of PC?</li><li>• Whether this terminal operates normally when being inserted into another PC?</li><li>• Whether this terminal operates normally when PC is reset to its default?</li></ul> ※For inquiries related to OS or PC, contact Microsoft or PC manufactures.
Internet connection speed decreased significantly	If insert this terminal into PC directly, use the supplied "USB extension cable (Sample)" when it is far from PC.
	Speed may turn slow in unsteady areas such as LTE/W-CDMA/HSDPA/HSUPA/GPRS service environment. Move it to another place and connect again.
Back cover L20 is deviated	Fit the back cover L20 to the ditch of back part and slide till it clicks.→P18

## Error Messages

Error Messages	Description
圏外	You are out of service area or available network.
使用可能ネットワークがありません。ネットワークを検索しますか。	You may be out of service area or available network, or network error. Set network setting again.
L-02C リセットに失敗しました。	This terminal failed in resetting. Check if this terminal is inserted correctly in PC and if it is recognized by PC.
接続中には設定変更できません。設定のためには接続を解除してください。	You cannot customize setting during data communication. Set again after closing data communication.
変更するPIN1コードと確認用のPIN1コードが異なります。再入力してください	Two of new PIN1 code are not identical each other. New PIN1 code you want to change is not matched to the PIN1 code you entered for verification purpose. Enter correct PIN1 code.
ドコモUIMカードが挿入されているか確認して下さい。	Make sure to insert UIM into this terminal before inserting to a PC.
L-02Cが取り外されました。	Do not remove this terminal while using this terminal.
PIN1コードの入力を3回失敗しました。PINロック解除コードを入力してください。	An incorrect PIN1 code was improperly entered 3 times in a row. Available functions will be limited. Enter unblocking PIN code to unlock.
PIN1コードが違います。PIN1コードを再入力してください。(リトライ〇/3)	An incorrect PIN1 code has been entered. Enter the correct PIN1 code again.
PIN1コードは、4～8桁の数字です	Valid PIN1 code is from 4 to 8 digits.
PIN1コードをPIN1ロックに設定してください。	To change the PIN1 code, PIN1 must be locked. Switch PIN1 unblocking to PIN1 blocking.
PIN1ロック解除コードが違います。再入力してください。(リトライ〇/10)	An incorrect unblocking PIN code was entered. Please enter the correct unblocking PIN code.
PINロック解除コードの入力を10回間違えたため、L-02Cがロックされました。ドコモの窓口までお問い合わせください。	You are no longer able to use UIM that unblocking PIN code has been improperly entered 10 times in a row. Please contact docomo Shop.

## Warranty and After-Sales Service

### Warranty

- A written warranty is provided with every terminal. Make sure that you receive it. Store the warranty in a safe place after you read it and verified that it contains the "Shop name/date" you purchased the product. If the written warranty does not contain the necessary information, contact the Shop where you purchased the product. The warranty is valid for a period of one year from the date of purchase.
- This product and all accessories are subject to change, in part or whole, for the sake of improvement without prior notice.

### After-Sales Service

#### If Problems Occur

- Before requesting service, read the "Troubleshooting" section in this manual. If the problem still persists, contact one of the numbers listed in "Repairs" (Japanese only) on the back of this manual.

### For Inquiries Result or When Repair is Required

- Take this terminal to a service center designated by DOCOMO. Be sure to check the operating hours of the service center. You must present the warranty. Please note that depending on malfunctions, it may take more than a day to repair.
- **In the warranty period**
- This terminal will be repaired at no charge subject to the conditions of the warranty.
  - The warranty must be presented to receive warranty service. The subscriber will be charged for the repair of items not covered in the warranty or repairs of defects resulting from misuse, accident or neglect even during the warranty period.
  - The subscriber is charged even during the warranty period for the repair of failures caused by the use of devices or consumable items that are not DOCOMO specified.
- **Repairs may not be possible in the following cases**
- When DOCOMO Repairs judges that this terminal is exposed to water. (Ex: the sticker is reacted to water)
  - Repair is not possible when corrosion due exposure to moisture, condensation or perspiration is detected in a moisture seal reaction or test, or if any of the internal boards are damaged or deformed.
  - ※ Since these conditions are outside the scope of the warranty, any repairs, if at all possible, will be charged.
- **After expiration of the warranty**  
All repairs that are requested are charged.

## ■ Replacement parts

Basically, replacement parts (parts required to maintain product function) will be kept in stock for at least 4 years after termination of production. Please note that the product may not be repaired even during this period, depending on the malfunctioning parts due to a shortage of those parts. Depending on the nature of the required repairs, it may still be possible to repair your terminal even after this period. Contact "Repairs" (Japanese only) listed on the back of this manual.

### Pay attention

- Do not modify this terminal, the UIM or its accessories.
  - Fire, injury or damage may result.
  - If this terminal is modified (part replacement, modification, painting, etc.), it will be repaired only after the modified parts have been restored to the condition at the time of purchase. However, repair may be refused depending on the nature of modification.  
Things like following cases will be regarded as modification of this terminal.
    - Using sticker to decorate this terminal
    - Exchanging the packing with those other than DOCOMO product
  - Repair of failures or damage caused by modification are charged even during the warranty period.
- Do not remove any inscription stickers attached to this terminal. The inscription stickers certify that this terminal satisfies specific technical standards. If stickers are removed intentionally or are reattached in such a way that confirmation of the sticker's contents is impossible, repair or servicing may be refused because confirmation of whether or not the device conforms to relevant technical standards cannot be made.

- Information of settings for each function may possibly be cleared (reset) due to the malfunction, repair or other treatment of this terminal.
- Take this terminal to the service center when the inner of this terminal is exposed to water or moisture. However, repairs may not be available for some conditions depending on this terminal.

## Updating Software

**Download the modification file of this terminal from download site on the Internet and then update the software. If software update is necessary, you will be informed at the DOCOMO website with "お知らせ (Information)".**

### Note

- Do not unplug this terminal with the computer during software update.
- Software update (downloading and rewriting) may take a while.
- If software update fails, all operations become unavailable. In this case, bring this terminal to a DOCOMO service center.



## Main Specifications

### ■ Operating system

Windows XP Home Edition Japanese version  
(Service Pack 3 or later)  
Windows XP Professional Japanese version  
(Service Pack 3 or later)  
Windows Vista 32bit Japanese version  
(Service Pack 2 or later)  
Windows Vista 64bit Japanese version  
(Service Pack 2 or later)  
Windows 7 32bit Japanese version  
Windows 7 64bit Japanese version  
Mac OS X 10.5.8 (32bit Japanese version)  
Mac OS X 10.6.4 (32bit Japanese version)

### ■ Communication Speed

- Up to 37.5Mbps for receiving data  
Up to 12.5Mbps for sending data  
(Part of the indoor facilities within Xi area can reach the speed of up to 75Mbps for receiving data and up to 25Mbps for sending data)
- ※ Communication speed is theoretical values when sending and receiving data which does not show the actual ones. The actual communication speed depends on communication environment and network congestion.
  - ※ Depending on the bandwidth of Xi area, the theoretical values is 100/100/75/37.5Mbps for receiving speed (bandwidth[20/15/10/5MHz]) and 50/37.5/25/12.5Mbps for sending speed (bandwidth [20/15/10/5MHz])
  - ※ Refer to DOCOMO website for detailed areas that support Xi.
  - ※ Receiving data up to 7.2Mbps, sending data up to 5.7Mbps in FOMA HIGH-SPEED area out of Xi area.
  - ※ Sending and receiving data may become up to 384kbps in the FOMA HIGH-SPEED area.
  - ※ Sending and receiving data become up to 384kbps in FOMA area out of Xi area and FOMA HIGH-SPEED area.

### ■ Operating environments

Temperature : 5°C to 35°C  
Humidity : 45% to 85%

## ■ Power source

### Power voltage

DC5V (Supplied from PC)

### Max Current consumption\*1

Max Current consumption while communicating  
LTE: Approx. 680mA or below (5/10MHz)\*2  
3G: Approx. 520mA or below  
GPRS: Approx. 570mA or below

Average Current consumption while communicating  
LTE: Approx. 380mA or below (5/10MHz)\*3  
3G: Approx. 310mA or below  
GPRS: Approx. 220mA or below

Average Current consumption while Standby:  
LTE: Approx. 110mA or below  
3G: Approx. 100mA or below  
GPRS: Approx. 100mA or below

\*1 Depending on the usage, power consumption fluctuates.

\*2 Approx. 740mA or below for 15/20MHz.

\*3 Approx. 420mA or below for 15/20MHz.

## ■ Form factor

USB connection type

## ■ Dimensions

Height: Approx. 90mm  
Width: Approx. 35mm  
Depth: Approx. 12.9mm

## ■ Weight

Approx. 44g

---

## ■ JATE certification number

AD10-0278001

## Export Administration Regulations

Japan Export Control Regulations ("Foreign Exchange and Foreign Trade Law" and relevant laws and regulations) applies to this product and its accessories. If you export or re-export this product or its accessories, please follow the necessary procedures at your own risk and expense. For details on the procedures, contact the Ministry of Economy.

## European Union Directives Conformance Statement



Hereby, LG Electronics, Inc. declares that this product is in compliance with:

- The essential requirements and other relevant provisions of Directive 1999/5/EC
- All other relevant EU Directives

# CE0168

The above gives an example of a typical Product Approval Number.

## FCC Regulations

### Statement

This equipment has been tested and found to comply with the limits for a class B digital device, pursuant to Part 15 of the FCC Rules. These limits are designed to provide reasonable protection against harmful interference in a residential installation. This equipment generates uses and can radiate radio frequency energy and, if not installed and used in accordance with the instructions, may cause harmful interference to radio communications. However, there is no guarantee that interference will not occur in a particular installation. If this equipment does cause harmful interference or television reception, which can be determined by turning the equipment off and on, the user is encouraged to try to correct the interference by one or more of the following measures:

- Reorient or relocate the receiving antenna.
- Increase the separation between the equipment and receiver.
- Connect the equipment into an outlet on a circuit different from that to which the receiver is connected.
- Consult the dealer or an experienced radio/TV technician for help.

Change or Modifications that are not expressly approved by the manufacturer could void the user's authority to operate the equipment.

## Class B Compliance

This device and its accessories comply with part 15 of FCC rules.

Operation is subject to the following two conditions:

- This device & its accessories may not cause harmful interference.
- This device & its accessories must accept any interference received, including interference that may cause undesired operation.

## Body-worn Operation

This device has been tested for typical body-worn operations with the distance of 0.19 inches (0.5cm) from the user's body.

To comply with FCC RF exposure requirements, a minimum separation distance of 0.19 inches (0.5cm) must be maintained from the user's body.

## Consumer Information on SAR (Specific Absorption Rate)

**THIS DEVICE MEETS THE GOVERNMENT'S REQUIREMENTS FOR EXPOSURE TO RADIO WAVES.**

Your wireless device is a radio transmitter and receiver. It is designed and manufactured not to exceed the emission limits for exposure to radio frequency (RF) energy set by the Federal Communications 'Commission of the U.S. Government. These limits are part of comprehensive guidelines and establish permitted levels of RF energy for the general population. The guidelines are based on standards that were developed by independent scientific organizations through periodic and thorough evaluation of scientific studies.

The standards include a substantial safety margin designed to assure the safety of all persons, regardless of age and health. The exposure standard for wireless devices employs a unit of measurement known as the Specific Absorption Rate, or SAR.

The SAR limit set by the FCC is 1.6W/kg.

- ※ Tests for SAR are conducted using standard operating positions specified by the FCC with the device transmitting at its highest certified power level, the actual SAR level of the device while operating can be well below the maximum value. This is because the device is designed to operate at multiple power levels so as to use only the power required to reach the network. In general, the closer you are to a wireless base station antenna, the lower the power output.

Before a device is available for sale to the public, it must be tested and certified to the FCC that it does not exceed the limit established by the government-adopted requirement for safe exposure. The tests are performed in positions and locations (e.g., worn on the body) as required by the FCC for each model.

The highest SAR value for this device when worn on the body is 0.77W/kg.

The FCC has granted an Equipment Authorization for this device with all reported SAR levels evaluated as in compliance with the FCC RF emission guidelines. SAR information on this device is on file with the FCC and can be found under the Display Gant section of <http://www.fcc.gov/oet/ea/fccid/> after searching on FCC ID BEJL02C. Additional information about Specific Absorption Rates (SAR) can be found on the Cellular Telecommunications Industry Association (CTIA) website at <http://www.ctia.org/>.

## Intellectual Property Rights

### Copyrights and Rights of Portrait

Without permission of the copyright owner you may not duplicate, modify, transmit over public communication lines, etc. any document, image, music, software, or other content owned by a third party that you have used this product to download from an Internet website, etc., except for private uses such as duplication and indexing that are allowed by copyright law.

### Trademarks

- "FOMA" "i-mode" "i-appli" "mopera U" "WORLD WING" "Xi" and "Xi" logo are trademarks or registered trademarks of NTT DOCOMO, INC.
- Microsoft®, Windows®, Windows Vista® are trademarks or registered trademarks of Microsoft Corporation in United States and/or other countries.
- In this manual, each OS (Japanese version) is described in the following short form.
  - Windows 7 is short for Microsoft® Windows® 7 (Starter, Home Basic, Home Premium, Professional, Enterprise, Ultimate).
  - Windows Vista is short for Windows Vista® (Home Basic, Home Premium, Business, Enterprise, Ultimate).
  - Windows XP is short for Microsoft® Windows® XP Professional operating system or Microsoft® Windows® XP Home Edition operating system.
- OS may be written abbreviated such as Windows 7, Vista, XP.

- Apple, Apple logo, Mac, Mac OS, Macintosh are registered trademark of Apple Inc. of US and other countries.
- Adobe, Adobe Flash Player and Adobe Reader are either registered trademarks or trademarks of Adobe Systems Incorporated in the United States and/or other countries.
- Other company names or product names mentioned in this work are the trademarks or registered trademarks of their respective owners.

# Index

## A

- Antenna .....18
- APN setting tool
  - Setting Manually (For Windows)  
.....70
- AT Command List .....97
- AT Commands .....96
- Available Communications.....23

## B

- Back Cover..... 16, 18
- Basic package.....16

## C

- CE ..... 120
- Communication Speed ..... 119
- Communication Status Lamp .....18
- Configuring Dial-up Network Manually
  - For Windows .....73
- Configuring Network .....92
- Connecting this terminal to a PC ..24

## E

- Environment Configuration..... 56
- Error Messages ..... 116
- European Union Directives
  - Conformance Statement..... 120
- Export Administration Regulations  
..... 120

## F

- FCC Regulations ..... 121
- Flash Player .....37, 48
- Form factor..... 120
- Front Cover..... 18

## G

- GPRS..... 53

## H

- HSDPA ..... 53
- HSUPA ..... 53
- Hyper Terminal..... 71

## I

- Install
  - Communication configuration file  
(Driver only) .....34, 38
  - Flash Player on Macintosh ..... 48
  - Flash Player on Windows..... 37
  - L-02C Connection Software on  
Macintosh (including a driver) . 43
  - L-02C Connection Software on  
Windows (including a driver) .. 33

## L

- LTE..... 53
- L-02C Connection Software
  - Checking The Newest  
Version of Software..... 61
  - Configuring Network..... 92
  - Confirmating after Installation  
.....39, 46
  - Confirming the packet  
communication volume..... 56
  - Environment Configuration ..... 56
  - Launching and Exiting Connection  
Software (For Macintosh) .... 52
  - Launching and Exiting Connection  
Software (For Windows)..... 52
  - Resetting this terminal ..... 61
  - Set security..... 58
  - Setting a UIM ..... 57
  - Setting Profile..... 57

**M**

Main application screen . . . . .	53
Main specifications . . . . .	119
Mobile Broadband . . . . .	64
Mode Indication Lamp . . . . .	19

**N**

Names of Parts and Functions . . . .	18
Network type . . . . .	53

**O**

Operating Environments . . . . .	32, 119
Operation buttons . . . . .	54
Operation system . . . . .	119
Overseas Use	
Before Using Overseas . . . . .	91
Configuring Network . . . . .	92
Setting the Searching Method for Available Networks . . . . .	92
Own phone number . . . . .	54

**P**

Packet Communication	
Confirming the packet communication volume . . . . .	56
Disconnecting to packet communication . . . . .	55
Requirements for packet communication . . . . .	24
Start packet communication . . . .	54
Power source . . . . .	120
PWR Lamp . . . . .	18

**R**

Resetting this terminal . . . . .	61
Result Codes . . . . .	112

**S**

Security Code . . . . .	21
Set security . . . . .	58
Setting	
APN settings . . . . .	57, 70
Configuring Dial-up Network Manually . . . . .	73
Configuring Network . . . . .	92
Configuring Network Manually . .	70
Environment Configuration . . . .	56
Security settings . . . . .	57
Setting a UIM . . . . .	57
Setting APN . . . . .	57
Setting up . . . . .	30

**T**

Trademarks . . . . .	122
Troubleshooting . . . . .	113

**U**

UIM	
Changing PIN1 Code . . . . .	59
Entering PIN1 Code . . . . .	59
Inserting/Removing . . . . .	19
Locking PIN1 . . . . .	58
Unlocking PIN code setting . . . .	60
Unlocking PIN1 . . . . .	58
Uninstall	
L-02C Connection Software on Macintosh (including a driver) .	49
L-02C Connection Software on Windows (including a driver) . .	41
Updating Software . . . . .	118
USB Connector . . . . .	18

**V**

Version information . . . . .	53
-------------------------------	----

**W**

Warranty and After-Sales Service . . . . .	117
W-CDMA (3G) . . . . .	53
WORLD WING . . . . .	90

**Z**

Zero installation . . . . .	30
-----------------------------	----





You can register a confirmation/change of contracts, or request information material at the DOCOMO online.

From a PC My docomo (<http://www.mydocomo.com/>) ⇒ 各種お申込・お手続き (Subscriptions/Procedures) (Japanese only)

※ "docomo ID/Password" is required if you access the site from a PC.

※ If you do not have or remember the "docomo ID/Password", contact the "docomo Information Center" listed on the back of this manual.

※ Some contracts may not be available for using.

※ You may not be able to use online service due to system maintenance, etc.

## Don't forget your terminal... or your manners!

When using this terminal, be considerate and do not disturb people around you.

◎The following cases, be certain to turn off your PC in which this terminal is inserted.

### ■ Where use is prohibited

There are some places which this terminal can not be used. Be sure to turn off your PC in which this terminal is inserted.

※ Persons with electronic medical equipment are in places other than the actual wards. Make sure you have the power switched off even if you are in a lobby or waiting room.

### ■ While driving

Using this terminal interferes with safe driving and may be dangerous.

### ■ When in crowded places such as packed trains, where you could be near a person with an implanted cardiac pacemaker or implanted defibrillator

The implanted cardiac pacemaker or implanted defibrillator operation can be adversely affected.

### ■ When in theaters, movie theaters, museums, and similar venues

If you use this terminal where you are supposed to be quiet, you may disturb those around you.

## General Inquiries <docomo Information Center>

(Business hours: 9:00 a.m. to 8:00 p.m.)

 **0120-005-250** (toll free)

- \* Service available in: English, Portuguese, Chinese, Spanish, Korean.
- \* Unavailable from part of IP phones.

(Business hours: 9:00 a.m. to 8:00 p.m. (open all year round))

 From DOCOMO mobile phones  
(In Japanese only)

 From land-line phones  
(In Japanese only)

 (No prefix) **151** (toll free)

 **0120-800-000** (toll free)

- \* Unavailable from land-line phones, etc.
- \* Unavailable from part of IP phones.

● Please confirm the phone number before you dial.

● For Applications or Repairs and After-Sales Service, please contact the above-mentioned information center or the docomo shop etc. near you on the NTT DOCOMO website.

NTT DOCOMO website <http://www.nttdocomo.co.jp/english/>

## Loss or theft of this terminal or payment of cumulative cost overseas

<docomo Information Center> (available 24 hours a day)

From DOCOMO mobile phones

International call access code for  
the country you stay

**-81-3-6832-6600\*** (toll free)

- \* You are charged a call fee to Japan when calling from a land-line phone, etc.

From land-line phones

<Universal number>

International prefix number for  
the universal number

**-8000120-0151\***

- \* You might be charged a domestic call fee according to the call rate for the country you stay.

※ For international call access codes for major countries and universal number international prefix, refer to DOCOMO International Services website.

● If you lose your terminal or have it stolen, immediately take the steps necessary for suspending the use of this terminal.

● If this terminal you purchased is damaged, bring your terminal to a repair counter specified by DOCOMO after returning to Japan.





Don't forget your mobile phone ... or your manners!

- When using your mobile phone in a public place, don't forget to show common courtesy and consideration for others around you.

## Repairs

(Business hours: 24 hours. (open all year round))

 From DOCOMO mobile phones  
(In Japanese only)

 From land-line phones  
(In Japanese only)

 (No prefix) **113** (toll free)

- \* Unavailable from land-line phones, etc.

 **0120-800-000** (toll free)

- \* Unavailable from part of IP phones.

## Failures encountered overseas

<Network Support and Operation Center> (available 24 hours a day)

From DOCOMO mobile phones

International call access code for  
the country you stay

**-81-3-6718-1414\*** (toll free)

- \* You are charged a call fee to Japan when calling from a land-line phone, etc.

From land-line phones

<Universal number>

International prefix number for  
the universal number

**-8005931-8600\***

- \* You might be charged a domestic call fee according to the call rate for the country you stay.

※ For international call access codes for major countries and universal number international prefix, refer to DOCOMO International Services website.

Sales: NTT DOCOMO, INC.

Manufacturer: LG Electronics Inc.